

ATTACHMENT A

**PLANNING PROPOSAL: GREEN SQUARE
AQUATIC CENTRE AND GUNYAMA PARK
(EPSOM PARK), ZETLAND AND
KELICK STREET, WATERLOO
DATED AUGUST 2014**

Planning Proposal

Green Square Aquatic Centre and Gunyama Park (Epsom Park), Zetland and Kellick Street, Waterloo

(132-138 & 140 Joynton Ave & 94-104 Epsom Rd, Zetland
75-77 Kellick Street, Waterloo)



August 2014

ATTACHMENT A

ATTACHMENT A

Contents

| | |
|--|----|
| Introduction | 4 |
| Background | 4 |
| Part 1: Objectives/Intended Outcome | 8 |
| Part 2: Explanation of provisions | 8 |
| Part 3: Justification | 10 |
| Section A – Need for the Planning Proposal | 10 |
| Section B – Relationship to strategic planning framework | 10 |
| Section C – Environmental, social and economic impact | 16 |
| Section D – State and Commonwealth interests | 19 |
| Part 4: Mapping | 20 |
| Part 5: Community Consultation | 23 |
| Part 6: Project Timeline | 24 |

Appendices

- 1. Green Square Aquatic Centre and Gunyama Park:
Site Layout document**

Introduction

This Planning Proposal explains the intent of, and justification for, the proposed amendment to *Sydney Local Environmental Plan 2012* (Sydney LEP 2012). This amendment will change the zoning and height controls for the Green Square Aquatic Centre site located at 132-138 and 140 Joynton Ave, Zetland, and the zoning controls for the neighbouring Council property at 94-104 Epsom Road, Zetland and 75-77 Kellick Street, Waterloo. The Proposal also outlines minor amendments to the height of buildings to other properties in the Epsom Park Precinct.

The amendment will help to facilitate the development of and operation of the Green Square Aquatic Centre, which will be the subject of a design competition in early 2014. The changes to the zoning for the other Council-owned sites will return those sites to the intended level of flexibility of land uses on those sites that was previously permissible under the *South Sydney Local Environmental Plan 1998 (as amended)*. Under the current Sydney LEP 2012, the sites are zoned SP2 Infrastructure (Community Facility). This is restrictive to the operation of the proposed Aquatic Centre as the zone prohibits any retail or commercial operations, and to the Kellick Street site, which is no longer considered appropriate for a community facility.

The amendment also seeks to reduce the maximum height controls for the proposed Aquatic Centre from 45 metres to a height of 27 metres, which is appropriate to accommodate the proposed land use. The height limit applying to the neighbouring Gunyama Park will also be reduced to reflect the area of the park. This will give more certainty and reassurance to the community and neighbouring landowners about the scale of the Aquatic Centre development and the location of the park.

An amendment to the *City of Sydney Development Control Plan 2012* (Sydney DCP 2012) accompanied this planning proposal on public exhibition. This amendment will amend the height controls for the Green Square Aquatic Centre site, will reinforce the role of the Aquatic Centre and neighbouring Gunyama Park as community assets, and will also amend the proposed street layout and building envelopes for properties at the corner of Epsom Road and Joynton Avenue to accommodate the stormwater network. The building envelopes and heights set out in the DCP will also be realised in minor changes to the Height of Buildings Map in the LEP.

This proposal has been prepared in accordance with Section 55 of the *Environmental Planning and Assessment Act 1979* (the Act) and guidelines published by the Department of Planning and Infrastructure in October 2012, namely 'A Guide to Preparing Planning Proposals' and 'A Guide to Preparing Local Environmental Plans'.

Background

Epsom Park Precinct

The Epsom Park Precinct is a relatively flat 19ha area, located in the suburb of Zetland, within the Green Square Urban Renewal Area and approximately 5 km south of Central Sydney. Adjacent to Epsom Park Precinct is the Green Square Town Centre – a new major centre around the Green Square Railway Station. The Town Centre is identified as a ‘Planned Major Centre’ in the NSW Government’s Metropolitan Plan for Sydney 2036 and the Draft Metropolitan Strategy for Sydney to 2031. It is also identified as a future village centre in the City’s Sustainable Sydney 2030 Strategy.

The Precinct, shown in Figure 1, comprises 11 large lots, owned by seven landowners, with the City of Sydney owning three lots. The Precinct is situated between the Victoria Park residential precinct, which is nearing completion to the north, and the emerging North Rosebery mixed use precinct to the south. A transit corridor, Zetland Avenue/Defries Avenue runs through the Precinct, connecting it with Green Square Town Centre and other neighbourhoods to the north. Link Road and South Dowling Street mark the eastern boundary. The land slopes gently from east to west.

The Precinct formed part of Waterloo Swamp, which was drained to form the Victoria Park Race course in the early 1900s. In the 1950s, BMC Leyland sited a factory in the north of the precinct and other motor car businesses followed. The predominant land use is now light industrial, with service depots (including for the City of Sydney), warehousing and distribution, a vehicle showroom and offices located in the Precinct. Development is generally large in footprint and 1-2 storeys high.

An Epsom Park Precinct Masterplan was prepared by Conybeare Morrison for the City of Sydney in April 2010. This document set out the desired urban character and urban form, identifying a hierarchy of streets, open spaces and development parcels. It helped to inform the proposed built form, as represented in the Sydney DCP 2012.

According to the Sydney DCP 2012, Epsom Park Precinct will be a new neighbourhood with a strong sense of place and public life. It will have a strong urban character and identity and is to provide a fine grain permeable built form that offers a range of dwelling types. The DCP refers to a central neighbourhood park of approximately 15,500 square metres providing space for active sports and passive recreation. This space has been named Gunyama Park.

The boundary of the Precinct is shown at Figure 1 below.

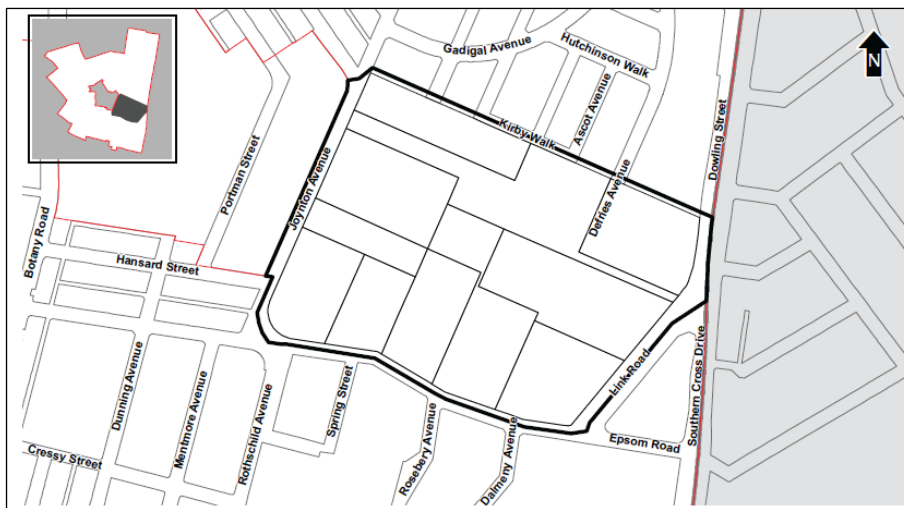

Figure 1: Epsom Park Precinct

ATTACHMENT A

Green Square Aquatic Centre and Sydney City Council Depot site

The former South Sydney Council offices site, located at 132-138 and 140 Joynton Avenue has a total area of 2.74 hectares and is located in the north-west of the Precinct. The site is currently used for equipment hire, and has been identified as the future site for Green Square Aquatic Centre and Gunyama Park. The Centre will accommodate a 50 metre pool, 25 metre pool, hydrotherapy pool, recreational pools, and administration and fitness facilities in approximately 9,000 square metres of floorspace and 2 storeys (although the final number of storeys may change subject to design). The proposed Gunyama Park adjacent to the facility is required to cater for active recreation on a multi-purpose playing field and passive recreational spaces. Refer to Appendix 1 for the site layout document.

Part of the land required for Gunyama Park is located on property currently owned by Lincon Development Pty Ltd. In accordance with a Voluntary Planning Agreement between Council and Lincon Development Pty Ltd (as exhibited on 5 July 2013), the landowner has committed to dedicate the rear portion of the land (approximately 4,700 square metres) for open space, by way of a Development Application for Subdivision to be approved by Council.

The City is currently undertaking a national design competition for the Aquatic Centre and Gunyama Park. The winner will undertake detailed design and construction documentation, leading to submission of a Development Application for the site in early 2015. Completion is planned for 2018.

94-104 Epsom Road is currently used by the City of Sydney as a Council depot facility, and there are no immediate plans for redevelopment of this site, although it is envisaged it will be redeveloped in the future as mixed use/residential or for public uses.

The boundaries of the Aquatic Centre site and Council Depot site are shown at Figure 2.



Figure 2: Green Square Aquatic Centre site and neighbouring properties

ATTACHMENT A

75-77 Kellick Street, Waterloo

75-77 Kellick Street is a Council-owned property of approximately 450 square metres on a quiet residential street in Waterloo. It houses a community building, which is now vacant following the relocation of its previous occupier, the AIDS luncheon club. Council's analysis of the site has found that there are no other viable community uses. The Council resolved on 5 December 2011 to endorse the sale of the site, with proceeds from the sale to be held as restricted funds within the Community Facilities reserve. The properties on either side (71-73 Kellick Street and 79 Kellick Street) are owned by the NSW Housing Corporation. The predominant land use surrounding the site is residential and the site is directly opposite a housing development known as Kensington Mews. The boundary of the Kellick Street site is shown at Figure 3 below.

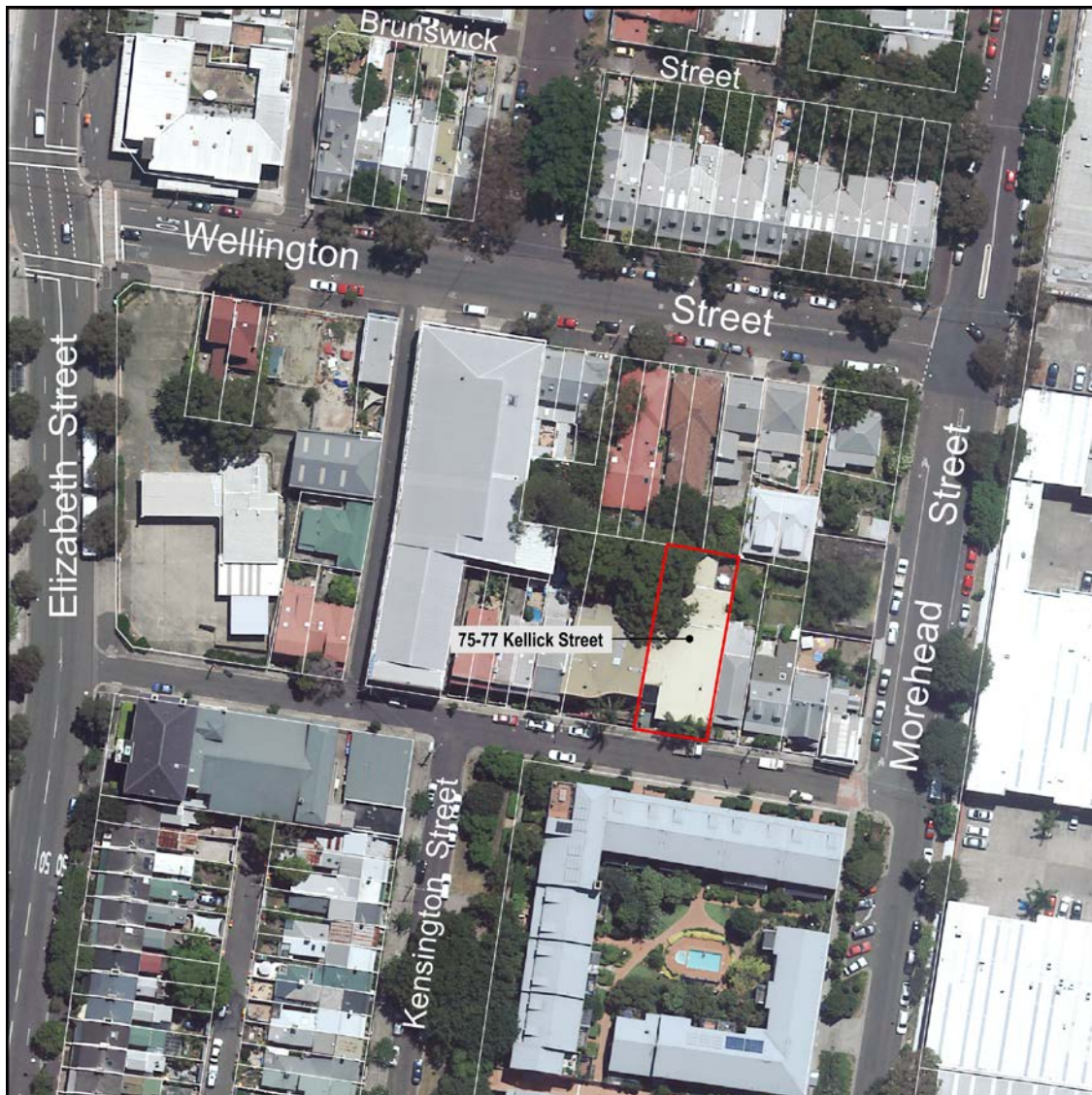

Figure 3: Kellick Street, Waterloo

ATTACHMENT A

This Planning Proposal proposes an amendment to the controls for the sites listed in Table 1 below. The summary and justification for the changes to the controls for each site are individually addressed on the following pages.

Table 1 – Site Description and Proposed Amendment

| Site | Property Description | Proposed Amendment |
|---|--|--|
| 132-138 and 140 Joynton Ave, and 94-104 Epsom Rd, Zetland | Lot 2 DP 850686 Lot 2 DP 24134 Lot 5 DP 235181 | -To rezone the sites to accommodate flexibility in uses, from SP2 Infrastructure (Community Facility) to B4 Mixed Use. -To make changes to the Sydney LEP 2012 height map |
| 146-158 Joynton Avenue | Lot 11 DP 594967 | -To make changes to the Sydney LEP 2012 height map and building envelope to accommodate changes to road layout to match the alignment of the stormwater easement. |
| 84-92 Epsom Road, Zetland | Lot 12 DP 594967 | |
| 106-116 Epsom Road | Lot 12 DP 594967 | |
| 118-130 Epsom Road | Lot 7 DP 24134 | |
| 905 South Dowling Street | Lot 2 DP 830870 | |
| 130 Joynton Avenue | Lot 1 DP 850686 | |
| 75-77 Kellick Street, Waterloo | Lot 1 DP 91298 | -To rezone to accommodate flexibility in uses, from SP2 Infrastructure (Community Facility) to B4 Mixed Use. |

The Planning Controls

Land use zoning

The Sydney Local Environmental Plan 2012 (Sydney LEP 2012) was adopted by the City Of Sydney Council in 2012 and came into force on 12 December 2012.

Under the previous LEP, the *South Sydney Local Environmental Plan 1998* (as amended), sites used for public purposes such as schools and Council depots were zoned as Zone 5: Special Uses. This zone allowed (with consent) development permissible on neighbouring land. It was the City's intention that a similar flexibility be given to publicly-owned sites under the new Sydney LEP 2012 and to rezone the sites to B4 Mixed Use. Submissions received for the exhibition of the draft Sydney LEP 2012 raised concerns with the potential loss of community land that may have resulted from a more flexible B4 Mixed Use zone. In addressing these concerns it was decided to apply the more restrictive SP2 Infrastructure Zone, with a map notation of community facility.

This Planning Proposal seeks to amend Sydney LEP 2012 to change the zoning for the Council-owned sites to B4 Mixed Use to allow the intended uses as follows:

- 132-138 and 140 Joynton Ave: the City intends to develop this site for an Aquatic facility.
- 94-104 Epsom Rd, Zetland, the City intends this site to be redeveloped for mixed-use or public uses.
- 75-77 Kellick Street: To proceed with the sale of the site as resolved by Council on 5 December 2011 with proceeds from the sale to be held as internally restricted funds within

ATTACHMENT A

the Community Facilities Reserve. The site is located within a residential area and it is considered appropriate to return it to the intended original zoning that allowed for mixed use development. The most appropriate use for this site is considered to be residential.

Building Height and Floor Space Ratio

Under the Sydney LEP 2012, the building height controls for the Precinct vary across the sites: from 12 metres (at the rear of 132-138 Joynton Avenue) to 55 metres for the corner site (146-158 Joynton Avenue). These are shown at Figure 6.

It is proposed to amend the height limit applying to the Aquatic Centre site, from a maximum of 45 metres to a maximum of 27 metres across the site. It is also proposed to reduce the maximum height limit applying to Gunyama Park from 12 metres to 3 metres (which would exclude lighting poles), to reflect the intended park use and to ensure consistency with the height limit applied to future open space elsewhere in the renewal areas.

For the wider Precinct, further changes to the Height of Buildings Map are required to accommodate the realignment of streets to match the stormwater easement. Minor height amendments are proposed on some sites in the south west of the Precinct to ensure that the overall development potential and floor space ratio (FSR) achievable on each site remains the same as under the Sydney LEP 2012 and DCP 2012.

The FSR for the Precinct under Sydney LEP 2012 ranges from 0.6:1 for the Aquatic Centre and Gunyama Park site to 1.75:1 for some of the larger sites along Epsom Road. It is not proposed to change the FSRs as part of this planning proposal.

The current Height of Buildings Map for Kellick Street, Waterloo shows a permissible building height of 9 metres for the site and the FSR map shows an FSR of 1.25:1. It is not proposed to change these controls.

Part 1: Objectives/Intended Outcome

The purpose of the Planning Proposal for the Epsom Park Precinct and Kellick Street sites is:

- To facilitate the development of an Aquatic Centre in Epsom Park Precinct, and provide certainty for neighbouring property owners and the community about the potential height and building envelope for the Aquatic Centre and Gunyama Park.
- To reconfigure the building envelopes (including building heights) to accommodate changes to the stormwater and drainage arrangements for the precinct and to reflect FSRs achievable under the current controls.
- To return the land use zones applying to the Council-owned sites to the level of permissibility that was achievable under the South Sydney LEP 1998, allowing for commercial operation of the Aquatic Facility site and/or the location of ancillary café and retail facilities at the site. This would also allow residential development to occur on the Kellick Street site, which is considered to be the most appropriate land use, and mixed use development on the Epsom Park Depot site.

It is intended that the planning outcome meets the objectives of ensuring sufficient flexibility to accommodate the outputs of the Green Square Aquatic Centre design competition to be undertaken by the City. At the same time, it must ensure the design of the Aquatic Centre and Gunyama Park is appropriate in the context of the surrounding development.

Part 2: Explanation of provisions

To achieve the proposed outcomes, the Planning Proposal seeks to amend the planning controls in accordance with the following:

Amendments to zoning maps

Amend Sydney LEP 2012 Land Zoning Map in accordance with the proposed Land Zoning Maps at Figure 4 and 5 and Maps 1 and 2, Part 4 of this Planning Proposal. This amendment involves changing the land zoning from SP2 Infrastructure (Community Facility) to B4 Mixed Use for the properties 132-138 and 140 Joynton Avenue, 94-104 Epsom Road, Zetland and 75-77 Kellick Street, Waterloo.

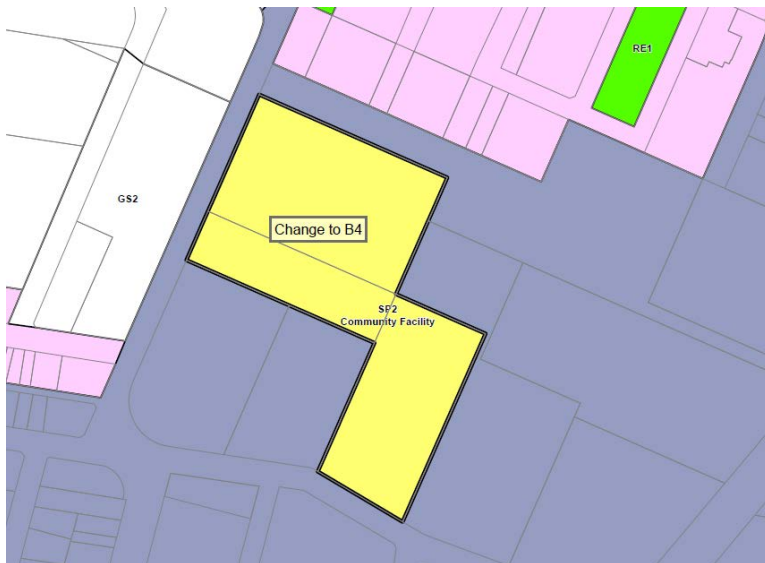

Figure 4: Proposed zoning change to 132-138 and 140 Joynton Avenue and 94-104 Epsom Road, Zetland

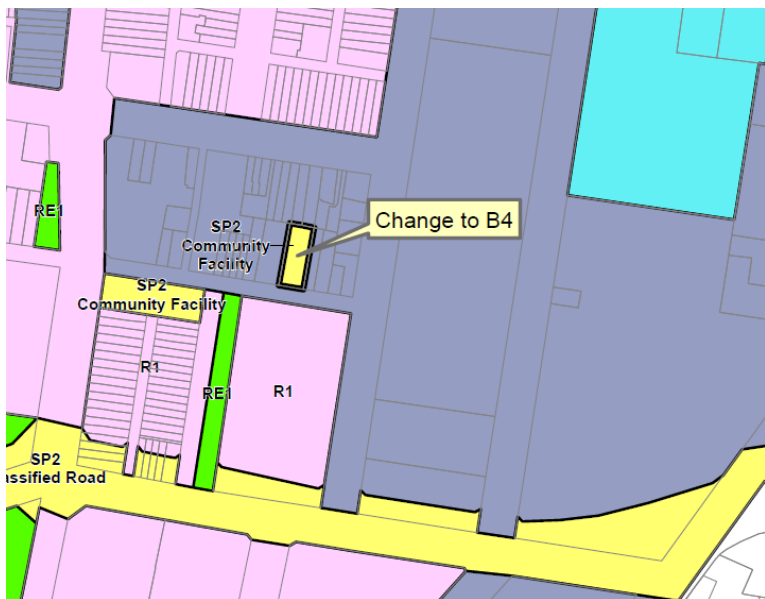

Figure 5: Proposed zoning change to 75-77 Kellick Street, Waterloo

ATTACHMENT A

Amendments to Height of Buildings Map

Amend Sydney LEP 2012 Height of Buildings Map in accordance with the proposed Height of Buildings Map at Figures 6 and 7 and Maps 3 and 4, Part 4 of this Planning Proposal. The current height map shown at Figure 6 shows a maximum permissible height of 45 metres for the 132-128 and 140 Joynton Avenue sites. The amendment, shown at Figure 7 reduces the maximum permissible height to 27 metres.

Further changes to building envelopes and heights across the Precinct are required to bring the document into line with the Sydney DCP 2012 and ensure that the current FSRs in Sydney LEP 2012 can be achieved despite the realignment of the road to accommodate the stormwater easement. These are also illustrated in Figure 7.

ATTACHMENT A



Figure 6: Current Height of Buildings map- Epsom Park Precinct Sydney LEP 2012



Figure 7: Proposed Height of Buildings map- Epsom Park Precinct

Part 3: Justification

Section A – Need for the Planning Proposal

1. *Is the Planning Proposal a result of any strategic study or report?*

In response to a recognised need for leisure and aquatic facilities to support the expanding population of Green Square, an Aquatic Leisure Facility Development Strategy was undertaken by the City in 2005. Council resolved to adopt the Strategy and prepare a feasibility study for locating the proposed Aquatic Facility at the former South Sydney Council offices site at 132-138 and 140 Joynton Avenue, Zetland.

The City's Open Space and Recreation Needs Strategy (2006) reinforced the findings of the Aquatic Leisure Facility Development Strategy and recognised the location of the facility on the Joynton Avenue sites as significant in providing a link between existing local open spaces in the Green Square area at Joynton Park, and Roseberry area, at Turruwul Park. This would help strengthen the distribution and connection of recreation facilities and open space in the southern area of the City.

The need for recreation and community facilities, including aquatic facilities, was set out in the *South Sydney Development Control Plan 1997- Part G: Special Precinct- Green Square*. The current Sydney DCP 2012 sets out the City's intention to provide a central district park in Epsom Park Precinct with space for a health and recreation centre.

2. *Is the Planning Proposal the best means of achieving the objectives or intended outcomes, or is there a better way?*

A Planning Proposal and amendment of the Sydney LEP 2012 is the most effective way of providing certainty for the local community and landowners about the future development of the sites and allowing orderly and economic development of the land.

Section B – Relationship to strategic planning framework

3. *Is the Planning Proposal consistent with the objectives and actions of the applicable regional or sub-regional strategy (including the Sydney Metropolitan Strategy and the exhibited draft strategies)?*

In March 2013 the NSW Government published the draft *Metropolitan Strategy for Sydney to 2031*. It was placed on public exhibition until 31 May 2013. Once adopted, it will replace the *Metropolitan Plan for Sydney 2036*. However, until that time, the *Metropolitan Plan for Sydney 2036* is the applicable adopted strategy. In assessing the consistency of this Planning Proposal with metropolitan wide objectives, both the adopted and new draft strategies have been considered. The consistency of this Planning Proposal with both draft and adopted Metropolitan Strategies and the *Sydney City Sub Regional Strategy* is illustrated in detail in Tables 2, 3 and 4.

Table 1 - Consistency with Metropolitan Plan for Sydney 2036

| Consistency with Metropolitan Plan for Sydney 2036 | |
|--|--|
| Action | Consistency |
| A: Strengthening a City of Cities | The Metropolitan Plan identifies Green Square as a 'Planned Major Centre' that will support central Sydney within a transport and economic network, offering housing, commercial activity and local services. Through facilitating the Green Square Aquatic Centre the proposal will support this objective. |

ATTACHMENT A

| Consistency with Metropolitan Plan for Sydney 2036 | |
|---|--|
| B: Growing and Renewing Centres | The Green Square Town Centre is identified as being located within the Global Economic Corridor and a 'Planned Major Centre'. The location of the Aquatic Centre adjacent to the town centre, combined with other proposed communities facilities nearby (library, community centre) will help to support economic growth and create jobs. |
| C: Transport for a Connected City | The Aquatic Centre will be located within walking distance of the Green Square Train Station. Current bus services travel along Joynton Avenue and Epsom Road, and future routes are also planned through the Town Centre. Parking will be limited at the site to further encourage sustainable travel. |
| D: Housing Sydney's Population | Changing the Kellick Street property to a mixed-use zoning will enable its development for housing, which is considered to be a more appropriate landuse than community facilities in this residential area. |
| E: Balancing Land Uses on the City Fringe | The proposal is not inconsistent with this objective. |
| F: Tackling Climate Change and Protecting Sydney's Natural Environment | <p>The proposed built form alignment is designed to accommodate the stormwater easement as part of a wider flood management strategy for Green Square and the Alexandra Canal. This will help contribute to the area's adaptation to increased extreme weather events under climate change scenarios.</p> <p>The brief for the Aquatic Centre will include a requirement to meet sustainability targets, including: energy-efficient design and fixtures, passive ventilation, indoor air quality and water reuse.</p> |
| G: Achieving Equity, Liveability and Social Inclusion | The Aquatic Centre and Gunyama Park will deliver enhanced liveability, equality and social inclusion through the delivery of a recreational facility and large area of open space with facilities available to all. |

Table 2 - Consistency with draft Metropolitan Strategy for Sydney to 2031

| Consistency with draft Metropolitan Strategy for Sydney to 2031 | |
|---|--|
| Objective | Consistency |
| 2: Strengthen and grow Sydney's centres | Locating an aquatic facility, park and sports field adjacent to the Green Square Town Centre will help to strengthen the function of the town centre. |
| 3: Make Sydney Connected | The facilities will be accessible via public transport, including via the Green Square train station, which will contribute towards the meeting of this objective. |
| 8: Create socially inclusive places that promote social, cultural and recreational opportunities | The Aquatic Centre, park and sports field will create recreational opportunities and will form socially inclusive spaces for the local and wider community. |
| 9: Deliver accessible and adaptable recreation and open space | The Planning Proposal will help to deliver accessible recreational facilities and a large area of open space. The design of the centre will be required to incorporate accessibility requirements and a hydrotherapy pool is also proposed, helping to meet the needs of a diverse population. |
| 26: Improve accessibility and connectivity for centres and for new urban areas | The Aquatic Centre and Gunyama Park design brief will ensure that accessibility and connectivity are key themes to be addressed. |

ATTACHMENT A

Table 3 - Consistency with Sydney City Draft Subregional Strategy

| Consistency with Sydney City Draft Subregional Strategy | |
|--|--|
| Strategy A: Economy and Employment | |
| Directions | Consistency |
| A2.3: Support magnet infrastructure A2.4: Utilise local assets to encourage learning and innovation | The location of an Aquatic Centre and sports field in Green Square may act as a magnet for other sport and health related infrastructure in the area. It will also provide educational facilities for use by local schools and groups (e.g. learn to swim classes). |
| Strategy B: Centres and Corridors | |
| Directions | Consistency |
| B4: Concentrate activities near public transport. C1: Ensure adequate supply of land and sites for residential development. | The proposal locates community facilities within close proximity to public transport, including the Green Square train station and future bus /light rail. It also allows residential development on the Kellick Street site and provides the potential for residential development on Epsom Road. |
| Strategy D: Transport | |
| Directions | Consistency |
| D3: Influence travel choices to encourage more sustainable travel. | The Aquatic Facility will ensure walking and cycling facilities and manage parking to assist in promoting sustainable transport choices. |
| Strategy E: Environment | |
| Directions | Consistency |
| E 5.3: Councils to identify natural hazards and risk management measures in Principal LEPs. | The changes to the building envelope for the Epsom Park Precinct proposed in this Planning Proposal respond to a requirement for flood management measures. The realignment of Rose Valley Way will accommodate stormwater management infrastructure, in support of this objective. |
| Strategy F: Parks and Public Places | |
| Directions | Consistency |
| F1: Increase access to quality parks and public places. F2: Provide a diverse mix of parks and public places. | New informal and formal public open space will be provided at Gunyama Park, alongside the Aquatic Centre, contributing to the mix of parks and open spaces in the Green Square area. |

4. Is the Planning Proposal consistent with a council's local strategy or other local strategic plan?

Sustainable Sydney 2030 (SS2030) is the vision for sustainable development of the City to 2030 and beyond. It includes 10 strategic directions to guide the future of the City, as well as 10 targets against which to measure progress. Table 4 shows the consistency of this Planning Proposal with key directions of SS2030.

Table 4 - Consistency with Sustainable Sydney 2030

| Consistency with Sustainable Sydney 2030 | |
|--|---|
| Direction | Comment |
| Direction 1 – A globally competitive and innovative city | The proposal supports innovation through helping facilitate an aquatic facility that will be selected through an international design competition. |
| Direction 2 – A leading environmental performer | The Aquatic Centre brief will require a high standard of sustainability performance in line with the City's commitment to reducing its environmental footprint. This will include water management and reuse, and energy efficient design and fixtures. |

ATTACHMENT A

| Consistency with Sustainable Sydney 2030 | |
|--|--|
| Direction | Comment |
| Direction 3 – Integrated transport for a connected city | The Aquatic Centre will be located within walking distance of the Green Square train station. Current bus services travel along Joynton Avenue and Epsom Road, and future routes are also planned through the Town Centre. Parking will be limited at the site to further encourage sustainable travel. |
| Direction 4 – A city for pedestrians and cyclists | Car-based travel will be discouraged at the Aquatic Centre site through limiting parking. Cycling and pedestrian improvements are planned for the wider area. |
| Direction 5 – A lively and engaging city centre | The proposal does not contain any elements which are inconsistent with this direction. |
| Direction 6 – Vibrant local communities and economies | Through enabling the Aquatic Centre and associated activities (e.g. the proposed gymnasium and café within the centre), the Planning Proposal will help to provide vibrancy and support local employment and new business. |
| Direction 7 – A cultural and creative city | The Aquatic Centre and Gunyama Park will provide recreational and wider cultural opportunities for the Green Square community in support of this objective. The proposed international design competition for the aquatic facility will enhance design quality in this part of the City. |
| Direction 8 – Housing for a diverse population | The proposal provides for a more flexible zoning than currently exists under the Sydney LEP 2012, allowing the redevelopment of the Kellick Street site for residential use, and possible future redevelopment of Council's Epsom Park site (the depot). |
| Direction 9 – Sustainable development, renewal and design | The design brief for the Aquatic Centre design will include requirements to meet the City's standards relating to sustainability during the construction and operational stage of the building. This will include water management and reuse, waste management and energy efficient design and fixtures. |
| Direction 10 – Implementation through effective partnerships | The ongoing design and development of the Aquatic Centre and Gunyama Park has involved consultation with authorities (including Sydney Water), landowners and the local community. This will continue to occur on an ongoing basis. |

5. Is the Planning Proposal consistent with applicable State Environmental Planning Policies (SEPPs)?

The consistency of the Planning Proposal with applicable State Environmental Planning Policies (SEPPs) is outlined in Table 5. Table 6 shows the consistency of the Planning Proposal with former Regional Environmental Plans (REPs) for the Sydney and Greater Metropolitan Regions, which are deemed to have the weight of SEPPs. Those SEPPs which have been repealed or were never finalised are not included in this table.

Table 5 - Consistency with State Environmental Planning Policies (SEPPs)

| State Environmental Planning Policy (SEPP) | Comment |
|--|--|
| SEPP No 1—Development Standards | Not applicable. |
| SEPP No 4—Development Without Consent and Miscellaneous Exempt and Complying Development | Not applicable. |
| SEPP No 6—Number of Storeys in a Building | Consistent - The Planning Proposal does not contain provisions that contradict or would hinder application of this SEPP. |
| SEPP No 10—Retention of Low Cost Rental Accommodation | Not applicable. |
| SEPP No 14—Coastal Wetlands | Not applicable. |
| SEPP No 15—Rural Landsharing Communities | Not applicable. |
| SEPP No 19—Bushland in Urban Areas | Not applicable. |
| SEPP No 21—Caravan Parks | Not applicable. |

ATTACHMENT A

| State Environmental Planning Policy (SEPP) | Comment |
|--|---|
| SEPP No 22—Shops and Commercial Premises | Consistent - The Planning Proposal does not contain provisions that contradict or would hinder application of this SEPP. |
| SEPP No 26—Littoral Rainforests | Not applicable. |
| SEPP No 29—Western Sydney Recreation Area | Not applicable. |
| SEPP No 30—Intensive Agriculture | Not applicable. |
| SEPP No 32—Urban Consolidation (Redevelopment of Urban Land) | Consistent- The Planning Proposal will help to support urban renewal in Green Square. |
| SEPP No 33—Hazardous and Offensive Development | Consistent - The Planning Proposal does not contain provisions that contradict or would hinder application of this SEPP. |
| SEPP No 36—Manufactured Home Estates | Not applicable. |
| SEPP No 39—Spit Island Bird Habitat | Not applicable. |
| SEPP No 41—Casino Entertainment Complex | Not applicable. |
| SEPP No 44—Koala Habitat Protection | Not applicable. |
| SEPP No 47—Moore Park Showground | Not applicable. |
| SEPP No 50—Canal Estate Development | Not applicable. |
| SEPP No 52—Farm Dams and Other Works in Land and Water Management Plan Areas | Not applicable. |
| SEPP No 53—Metropolitan Residential Development | Not applicable. |
| SEPP No 55—Remediation of Land | Consistent - The Planning Proposal does not contain provisions that contradict or would hinder application of this SEPP. Remediation is required for a number of sites within the Epsom Park Precinct, including the Aquatic Centre site and Council depot site. Further details are provided in Section 3, part C of this Planning Proposal. |
| SEPP No 59—Central Western Sydney Regional Open Space and Residential | Not applicable. |
| SEPP No 60—Exempt and Complying Development | Not applicable. |
| SEPP No 62—Sustainable Aquaculture | Not applicable. |
| SEPP No 64—Advertising and Signage | Not applicable. |
| SEPP No 65—Design Quality of Residential Flat Development | Consistent - The Planning Proposal does not contain provisions that contradict or would hinder application of this SEPP. |
| SEPP No 70—Affordable Housing (Revised Schemes) | Consistent - The Planning Proposal does not contain provisions that contradict or would hinder application of this SEPP. The Green Square Affordable Housing Scheme applies to the Precinct. |
| SEPP No 71—Coastal Protection | Not applicable. |
| SEPP (Building Sustainability Index: BASIX) 2004 | Consistent - The Planning Proposal does not contain provisions that contradict or would hinder application of this SEPP. |
| SEPP (Housing for Seniors or People with a Disability) 2004 | Consistent - The Planning Proposal does not contain provisions that contradict or would hinder application of this SEPP. |
| SEPP (Major Development) 2005 | Consistent - The Planning Proposal does not contain provisions that contradict or would hinder application of this SEPP. |
| SEPP (Sydney Region Growth Centres) 2006 | Not applicable. |
| SEPP (Infrastructure) 2007 | Consistent - The Planning Proposal does not contain provisions that contradict or would hinder application of this SEPP. |
| SEPP (Kosciuszko National Park—Alpine Resorts) 2007 | Not applicable. |
| SEPP (Mining, Petroleum Production and Extractive Industries) 2007 | Not applicable. |

ATTACHMENT A

| State Environmental Planning Policy (SEPP) | Comment |
|--|--|
| SEPP (Temporary Structures) 2007 | Consistent - The Planning Proposal does not contain provisions that contradict or would hinder application of this SEPP. |
| SEPP (Exempt and Complying Development Codes) 2008 | Consistent - The Planning Proposal does not contain provisions that contradict or would hinder application of this SEPP. |
| SEPP (Rural Lands) 2008 | Not applicable. |
| SEPP (Western Sydney Parklands) 2009 | Not applicable. |
| SEPP (Affordable Rental Housing) 2009 | Not applicable. |
| SEPP (Western Sydney Employment Area) 2009 | Not applicable. |
| SEPP (Development on Kurnell Peninsula) 2005 | Not applicable. |

Table 6 - Consistency with former Sydney and Greater Metropolitan Regional Environmental Plans (REPs)

| Regional Environmental Plan (REPs) | Comment |
|--|---|
| Sydney REP No 5—(Chatswood Town Centre) | Not applicable. |
| Sydney REP No 8 (Central Coast Plateau Areas) | Not applicable. |
| Sydney REP No 9—Extractive Industry (No 2—1995) | Not applicable. |
| Sydney REP No 11—Penrith Lakes Scheme | Not applicable. |
| Sydney REP No 13—Mulgoa Valley | Not applicable. |
| Sydney REP No 16—Walsh Bay | Not applicable. |
| Sydney REP No 17—Kurnell Peninsula (1989) | Not applicable. |
| Sydney REP No 18—Public Transport Corridors | Not applicable. |
| Sydney REP No 19—Rouse Hill Development Area | Not applicable. |
| Sydney REP No 20—Hawkesbury- Nepean River (No 2—1997) | Not applicable. |
| Sydney REP No 24—Homebush Bay Area | Not applicable. |
| Sydney REP No 25—Orchard Hills | Not applicable. |
| Sydney REP No 26—City West | Not applicable. |
| Sydney REP No 28—Parramatta | Not applicable. |
| Sydney REP No 29—Rhodes Peninsula | Not applicable. |
| Sydney REP No 30—St Marys | Not applicable. |
| Sydney REP No 33—Cooks Cove | Not applicable. |
| Sydney REP (Sydney Harbour Catchment) 2005 | Consistent - The Planning Proposal does not contain provisions that contradict or would hinder application of this REP. |
| Drinking Water Catchments REP No 1 | Not applicable. |
| Greater Metropolitan REP No 2— Georges River Catchment | Not applicable. |

6. Is the Planning Proposal consistent with applicable Ministerial Directions (s.117 directions)?

The Planning Proposal has been assessed against each Section 117 direction. The consistency of the Planning Proposal with these directions is shown in Table 7 below.

ATTACHMENT A

Table 7 - Consistency with applicable Ministerial Directions under Section 117

| No. | Title | Comment |
|--|--|--|
| 1. Employment and Resources | | |
| 1.1 | Business and Industrial Zones | Not applicable |
| 1.2 | Rural Zones | Not applicable |
| 1.3 | Mining, Petroleum Production and Extractive Industries | Not applicable |
| 1.4 | Oyster Aquaculture | Not applicable |
| 1.5 | Rural Lands | Not applicable |
| 2. Environment and Heritage | | |
| 2.1 | Environment Protection Zones | Not applicable |
| 2.2 | Coastal Protection | Not applicable |
| 2.3 | Heritage Conservation | Consistent- The Planning Proposal does not propose any changes that will hinder existing heritage conservation provisions. Kellick Street is located within a heritage conservation area and any future development would need to consider this. |
| 2.4 | Recreation Vehicle Areas | Not applicable |
| 3. Housing Infrastructure and Urban Development | | |
| 3.1 | Residential Zones | Not applicable |
| 3.2 | Caravan Parks and Manufactured Home Estates | Not applicable |
| 3.3 | Home Occupations | Not applicable |
| 3.4 | Integrating Land Use and Transport | Consistent- The Planning Proposal is consistent with the aims, objectives and principles of <i>Improving Transport Choice – Guidelines for planning and development</i> (DUAP 2001), and <i>The Right Place for Business and Services – Planning Policy</i> (DUAP 2001). |
| 3.5 | Development Near Licensed Aerodromes | Not applicable |
| 3.6 | Shooting Ranges | Not applicable |
| 4. Hazard and Risk | | |
| 4.1 | Acid Sulfate Soils | Consistent- The Epsom Park Precinct and Kellick Street are classified as Acid Sulfate Soils Class 5 in Sydney LEP 2012. An Acid Sulfate Soils Management Plan may be required for the redevelopment of sites prior to approval of a DA in accordance with the Sydney LEP 2012 requirements. |
| 4.2 | Mine Subsidence and Unstable Land | Not applicable |
| 4.3 | Flood Prone Land | Consistent- The Planning Proposal does not contradict or hinder application of flood prone land provisions in Sydney LEP 2012. The Aquatic Centre site is located in an area prone to flooding; however flood risk measures are being undertaken across the wider precinct to mitigate this risk and a flood assessment would be provided with the Development Application. Further details are provided in Part 3, Section C of this Planning Proposal. Kellick Street is not located in an area prone to flooding. |
| 4.4 | Planning for Bushfire Protection | Not applicable |
| 5. Regional Planning | | |
| 5.1 | Implementation of Regional Strategies | Not applicable |
| 5.2 | Sydney Drinking Water Catchments | Not applicable |
| 5.3 | Farmland of State and Regional Significance on the NSW Far North Coast | Not applicable |

ATTACHMENT A

| | | |
|---------------------------------|--|--|
| 5.4 | Commercial and Retail Development along the Pacific Highway, North Coast | Not applicable |
| 5.8 | Second Sydney Airport, Badgerys Creek | Not applicable |
| 6. Local Plan Making | | |
| 6.1 | Approval and Referral Requirements | Consistent- The Planning Proposal does not require any additional concurrence, consultation or referral provisions nor does it identify any development as designated development. |
| 6.2 | Reserving Land for Public Purposes | The Planning Proposal does not propose to reserve any land for public purposes. |
| 6.3 | Site Specific Provisions | Not applicable |
| 7. Metropolitan Planning | | |
| 7.1 | Implementation of the Metropolitan Plan for Sydney 2036 | Consistent- The Planning Proposal does not contradict or hinder application of the Metropolitan Plan for Sydney 2036. |

Section C – Environmental, social and economic impact

7. *Is there any likelihood that critical habitat or threatened species, populations or ecological communities, or their habitats, will be adversely affected as a result of the proposal?*

The land subject to this Planning Proposal has been previously developed and has not been identified as containing critical habitat or threatened species, populations or ecological communities, or their habitats.

The Planning Proposal provides opportunity for the enhancement of local biodiversity through the establishment of Gunyama Park.

8. *Are there any other likely environmental effects as a result of the Planning Proposal and how are they proposed to be managed?*

The proposed amendments to Sydney LEP 2012 are unlikely to result in environmental effects that cannot be controlled through existing policies, regulations and standards. This will ensure that environmental impacts are mitigated during the construction and operational phase of development.

The reduction in height controls applying to the Aquatic Centre site, proposed in this planning proposal, is likely to reduce adverse environmental effects from overshadowing and overlooking that may have occurred under the existing Sydney LEP 2012 height controls.

The key environmental considerations arising from the Planning Proposal relate to transport and traffic, flooding, contamination, Ecologically Sustainable Development, and amenity. These are discussed in further detail below.

Transport and traffic

The Epsom Park Precinct, in particular the eastern edge of the Precinct, is well located to existing and proposed public transport. The site of the proposed Aquatic Centre is approximately 500 metres walking distance to the Green Square train station. A proposed transport corridor along Zetland Avenue to the north of the site will provide light rail services in the long term.

Regular bus services to the City, Bondi Junction, Eastgardens and Botany are currently available along Joynton Avenue, with future additional services also considered in the Green Square Renewal Area Transport Management and Accessibility Plan 2012, prepared by the NSW Government's Transport for NSW.

Whilst access via public transport, walking and cycling will be encouraged in the Aquatic Centre development design and operation, there will be some need for parking facilities, including disabled parking. A study is being commissioned by the City to investigate how much parking demand will be generated by the Aquatic Centre and how this may be accommodated.

ATTACHMENT A

The property at 75-77 Kellick Street, Waterloo is on a narrow street with limited on-street parking. The controls for the site enable a maximum of two residential storeys and relatively low FSR of 1.25:1; therefore its rezoning to allow for mixed-use development is unlikely to increase parking requirements on the street. The property is close to Elizabeth Street and Bourke Street which are served by buses.

Flooding

Joynton Avenue at the proposed intersection with Zetland Avenue was once part of Waterloo Swamp. The intersection is much lower than surrounding land and serves as a de-facto detention basin in flood events. The need to provide flood mitigation in this Precinct and the wider Green Square area has long been recognised and the City has been working with Sydney Water and the Department of Planning and Infrastructure to develop a strategy and funding to support this. A Floodplain Risk Management Plan was completed by the City in May 2013, which includes details of proposed major trunk upgrades from Link Road, through the Green Square Town Centre and to Alexandra Canal. These works are being driven by Sydney Water and will be part-funded by the City and the Department. This constitutes a significant investment in stormwater and flood management infrastructure to manage flood risk in the Green Square catchment.

For the Green Square Aquatic Centre, further detailed assessment is being undertaken to ascertain flooding levels and to ensure the development does not increase flood risk elsewhere and a detailed hydrological assessment will accompany the Development Application.

The property at 75-77 Kellick Street site is not subject to flood risk.

Contamination

The Council-owned properties at 132-138 Joynton Avenue & 140 Epsom Road are contaminated with heavy metals (lead and copper), Polycyclic Aromatic Hydrocarbons (PAHs) and benzene. A Phase 2 Environmental Site Assessment was undertaken in 2008 which included findings from previous studies. It concluded that whilst soil contamination above the NSW Department of Environment and Climate Change (DECC) endorsed assessment criteria had been identified, the sites could be made suitable for redevelopment via remediation and management. Through groundwater testing, the study also found that there is potential for contamination to exist at other site locations, but that the identified groundwater contamination would be unlikely to preclude site suitability for re-development.

Approximately 4,700 square metres of the proposed Gunyama Park is known as the Lincon site, and also has some contamination associated with its past industrial uses. The applicant submitted a Remediation Action Plan (RAP) and Interim Advice Letter as part of the DA for 106-116 Epsom Rd. The site auditor concluded that the site can be made suitable for its proposed use following remediation. The City will need to remediate the rear portion of the site once it has been dedicated and is ready to be redeveloped as Gunyama Park.

Further information and clarification regarding contamination will be a requirement at the detailed Development Application stage for any future development, given the past industrial uses of the sites. Details will also be provided about earth works required as part of the Aquatic Centre Construction and in relation to any basement parking.

There are no known major concerns regarding contamination of the Kellick Street site.

Ecologically Sustainable Development

The Planning Proposal is unlikely to result in changes that will have a significant environmental impact; however it will facilitate development of an Aquatic Centre, a type of facility that is usually a large user of water and energy. In Sydney, aquatic centres owned and operated by councils use around 1,000 megalitres of water a year¹, with three quarters of this being discharged to the wastewater system. Pool heating, equipment and hot water supply require large amounts of energy, and the overall carbon footprint of such a facility can be substantial.

¹ Sydney Water 2011: Best Practice Guidelines for Water Management in Aquatic Leisure Centres.

ATTACHMENT A

The design brief for the Aquatic Centre will include requirements for sustainable design to be built-in to the project, incorporating daylighting, natural ventilation, insulation, energy consumption and carbon footprint, Water Sensitive Urban Design (WSUD) and water reuse.

The future redevelopment of other sites within the Precinct and Kellick Street will be subject to Sydney LEP and DCP 2012 provisions that seek to achieve Ecologically Sustainable Development.

9. Has the Planning Proposal adequately addressed any social and economic effects?

The provision of an Aquatic Centre, playing fields and parklands in Green Square will provide significant positive social and economic benefits to the local area and the wider community in the south of the City. The health benefits to the existing and future community are of particular note and the provision of a hydrotherapy pool and accessible access will ensure the facility can be used by all sectors of the community, including the aged and people with disabilities.

When considered alongside the development of the Green Square Library and Plaza, and the community and creative centre at the former South Sydney Hospital site, the Aquatic Centre facilitated through this Planning Proposal will have a substantial positive long-term effect on community health, wellbeing and cohesion.

Through returning Council land to a zone that allows for a greater permissibility of uses, the Planning Proposal will further enhance the economic benefits that may occur through development of the Aquatic Centre, adding to the overall economic benefits associated with development at Green Square.

The rezoning of the Council's property at 75-77 Kellick St will allow the sale of the property to proceed and the funds to be used specifically for community facilities.

Amenity of public open space

This Planning Proposal seeks to vary the height controls and building envelope for the Epsom Park Precinct, in response to the need to accommodate a stormwater easement in the Precinct. The new alignment of Rose Valley Way has necessitated the realignment of building envelopes to accommodate the easement. This realignment has included consideration of privacy and overshadowing and is unlikely to have additional adverse effects.

The City is also seeking to ensure the Aquatic Centre site is not overdeveloped; and this Planning Proposal proposes to lower the height planes for the site from a maximum of 45 metres to 27 metres. The overall effect will increase amenity, through reduced overshadowing and overlooking to surrounding future development and reduced overshadowing of the public domain.

Section D – State and Commonwealth interests

10. Is there adequate public infrastructure for the Planning Proposal?

The Epsom Park Precinct is relatively well-served by public transport, and is around 800 metres walking distance from the Green Square train station. Once the proposed Zetland Avenue and other streets are developed in the Town Centre, it will be approximately 500 metres walking distance from the station. Regular bus services to the City, Bondi Junction, Eastgardens and Botany are currently available along Joynton Avenue, and services to Zetland, Coogee and Leichhardt are available along Epsom Road. Future additional services are also considered in the Green Square Renewal Area Transport Management and Accessibility Plan 2012, prepared by the NSW Government's Transport for NSW.

Civil and public domain infrastructure to serve the Precinct and the Green Square Town Centre will be progressively delivered with the redevelopment of sites including the Aquatic Centre.

ATTACHMENT A

11. What are the views of state and Commonwealth public authorities consulted in accordance with the Gateway determination?

The Gateway determination required public authority consultation to be undertaken with Transport for NSW (TfNSW) and the Roads and Maritime Services. The City considered it would also be appropriate to consult with the Office of Environment and Heritage, Sydney Airport Corporation Limited, Sydney Water, and the neighbouring Local Authorities, the City of Botany Bay Council and Randwick City Council.

Submissions were received from Transport for NSW, Roads and Maritime Services (RMS) and Randwick City Council, and were generally supportive of the proposal.

TfNSW expressed support for the pedestrian access provisions for the Aquatic Centre and Gunyama Park, but noted the need to safeguard existing bus services and bus stops.

The RMS raised no objection to the proposal.

Randwick City Council raised a number of concerns relating to the proposed street layout and the impacts on accessibility and visibility. This included the loss of one of the frontages to Gunyama Park, which had three street frontages under the current DCP 2012. Concerns were also raised about the delineation between public and private space for access ways between buildings. Randwick City Council also suggested that there is no legal necessity to rezone Council land from an infrastructure (SP2) to mixed use (B4) zoning, and suggested that an RE 1 zone may be more appropriate. A comment was also made on the need to accommodate the needs of drivers through providing appropriate parking at the Aquatic Centre.

In response:

- The City was required to change the street layout to accommodate Sydney Water requirements for construction not to occur over the stormwater drain, which has necessitated the changes to street layout.
- Public and private space will be clearly marked, with the City's standards for public domain design applied to public space.
- The rezoning was considered necessary to ensure consistency across the sites within Epsom Park and to allow for the range of uses required to support the Aquatic Centre.
- The City is aware of the importance of balancing sustainable transport with driver's needs and is undertaking to achieve this balance in planning the Aquatic Centre.

ATTACHMENT A

Part 4: Mapping

The Planning Proposal seeks to amend the Land Zoning and Height of Buildings Maps in the *Sydney Local Environmental Plan 2012* (Sydney LEP 2012) as shown at Maps 1- 4 below.

ATTACHMENT A

Map 1: Land Zoning Map – Sheet HOB_017 (Proposed)- Epsom Park Precinct, Zetland

Map 2: Land Zoning Map – Sheet HOB_017 (Proposed)- Kellick Street, Waterloo

Map 3: Height of Buildings Map – Sheet HOB_018 (Current) - Epsom Park Precinct, Zetland

Map 4: Height of Buildings Map – Sheet HOB_018 (Proposed)- Epsom Park Precinct, Zetland

ATTACHMENT A



RANDWICK LGA

Sydney Local Environmental Plan 2012

Land Zoning Map - Sheet LZN_018

Zone

- B1 Neighbourhood Centre
- B2 Local Centre
- B3 Commercial Core
- B4 Mixed Use
- B5 Business Development
- B6 Enterprise Corridor
- B7 Business Park
- B8 Metropolitan Centre
- IN1 General Industrial
- IN2 Light Industrial
- R1 General Residential
- R2 Low Density Residential
- RE1 Public Recreation
- SP1 Special Activities
- SP2 Infrastructure
- CW SREP 26 City West
- DH Darling Harbour Development Plan No. 1
- GAIIP Sydney LEP (Glebe Affordable Housing Project) 2011
- GSI1 South Sydney LEP 1998 and City of Sydney Planning Scheme Ordinance
- GS2 South Sydney LEP 1998 and South Sydney LEP 114
- HP Sydney LEP (Harold Park) 2011
- MD SEPP Major Development 2005
- MPS SEPP 47 Moore Park Showground
- SCRA Sydney Cove Redevelopment Authority Scheme
- SHC SREP Sydney Harbour Catchment 2005
- SLEP Sydney LEP 2005
- SS South Sydney LEP 1998
- WB SREP 16 Walsh Bay
- UL Unzoned Land
- Subject to Change

Cadastre

- Cadastre 14/10/2013 © City of Sydney

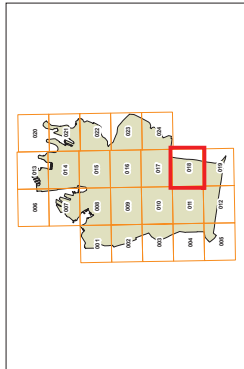

Projection: GDA 1984
Zone 56

ATTACHMENT A

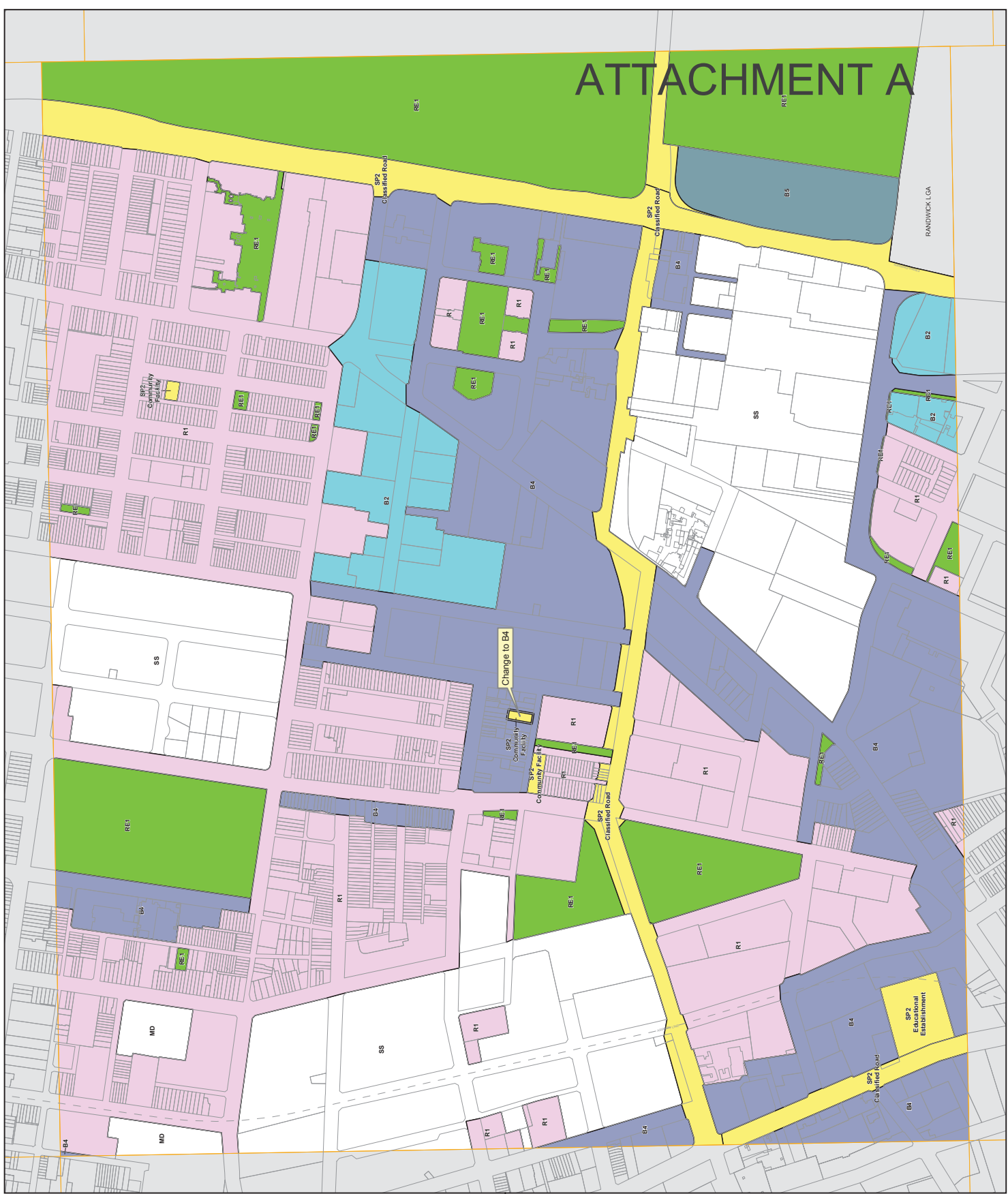

Sydney Local Environmental Plan 2012

Land Zoning Map - Sheet LZN_017

- Zone**
- B1 Neighbourhood Centre
 - B2 Local Centre
 - B3 Commercial Core
 - B4 Mixed Use
 - B5 Business Development
 - B6 Enterprise Corridor
 - B7 Business Park
 - B8 Metropolitan Centre
 - IN1 General Industrial
 - IN2 Light Industrial
 - R1 General Residential
 - R2 Low Density Residential
 - RE1 Public Recreation
 - SP1 Special Activities
 - SP2 Infrastructure
 - CW SREP 26 City West
 - DH Darling Harbour Development Plan No. 1
 - GAIIP Sydney LEP 1998 and City of Sydney Planning Scheme Ordinance
 - GS2 South Sydney LEP 1998 and South Sydney LEP 114
 - HP Sydney LEP (Harold Park) 2011
 - MD SEPP Major Development 2005
 - MPS SEPP 47 Moore Park Showground
 - SCRA Sydney Cove Redevelopment Authority Scheme
 - SHC SREP Sydney Harbour Catchment 2005
 - SLEP Sydney LEP 2005
 - SS South Sydney LEP 1998
 - WB SREP 16 Walsh Bay
 - UL Unzoned Land
 - U Subject to Change
- Cadastre**
- Cadastre 14/10/2013 © City of Sydney

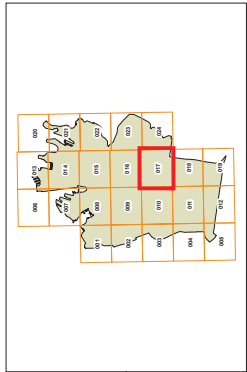



 Scale: 1:5,000 @ A3

 Projection: GDA 1984

 Zone 56

 Map identifier: splan_2012_LZN_017_005_20131014

ATTACHMENT A

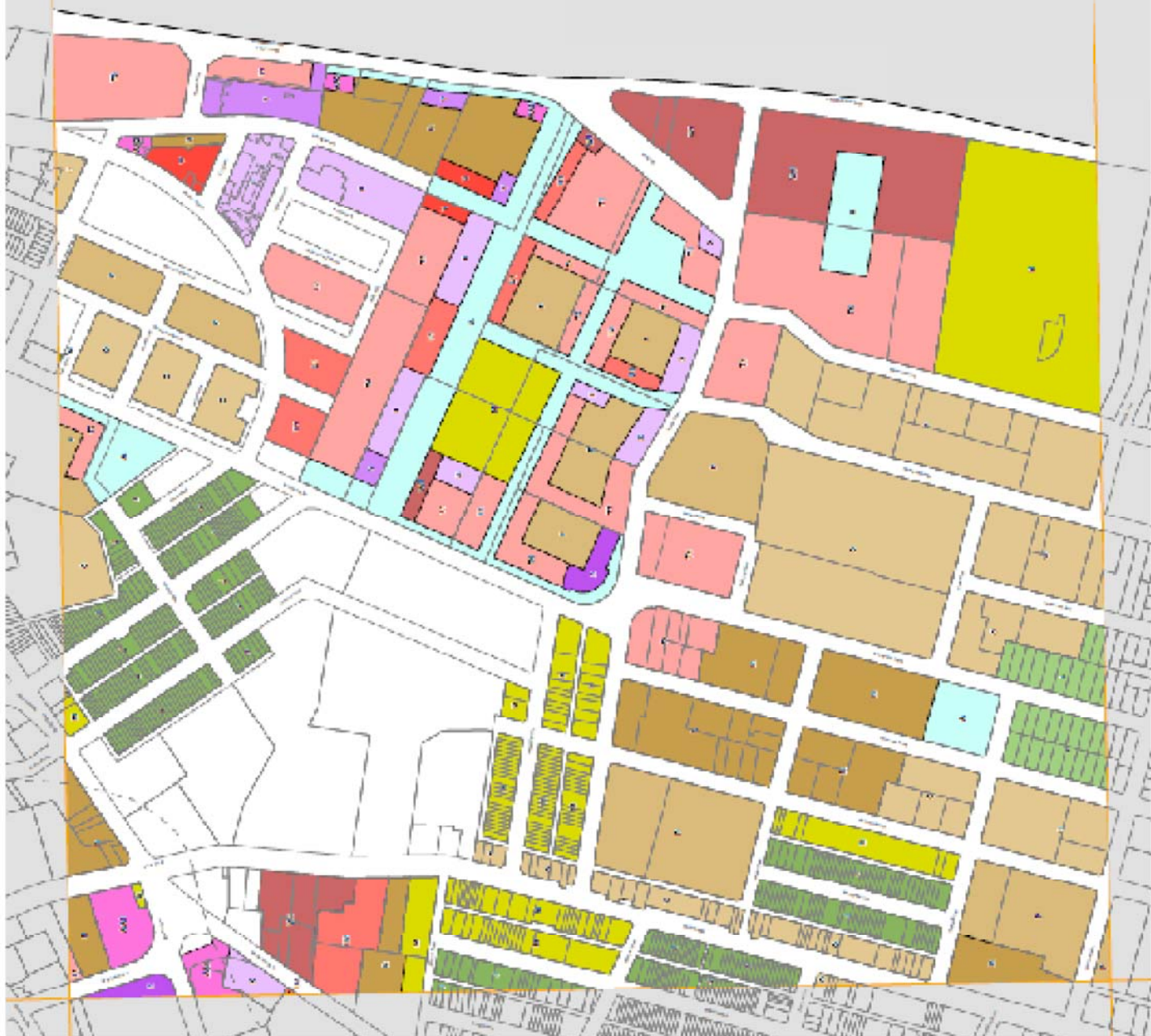

Height of Buildings Map
 - Street HIDE_DTB

| Minimum Building Height (m) | Maximum Building Height (m) (Height shown on map in R.L.M) |
|-----------------------------|--|
| 2 | 2 |
| 3 | 3 |
| 4 | 4 |
| 5 | 5 |
| 6 | 6 |
| 7 | 7 |
| 8 | 8 |
| 9 | 9 |
| 10 | 10 |
| 11 | 11 |
| 12 | 12 |
| 13 | 13 |
| 14 | 14 |
| 15 | 15 |
| 16 | 16 |
| 17 | 17 |
| 18 | 18 |
| 19 | 19 |
| 20 | 20 |
| 21 | 21 |
| 22 | 22 |
| 23 | 23 |
| 24 | 24 |
| 25 | 25 |
| 26 | 26 |
| 27 | 27 |
| 28 | 28 |
| 29 | 29 |
| 30 | 30 |
| 31 | 31 |
| 32 | 32 |
| 33 | 33 |
| 34 | 34 |
| 35 | 35 |
| 36 | 36 |
| 37 | 37 |
| 38 | 38 |
| 39 | 39 |
| 40 | 40 |
| 41 | 41 |
| 42 | 42 |
| 43 | 43 |
| 44 | 44 |
| 45 | 45 |
| 46 | 46 |
| 47 | 47 |
| 48 | 48 |
| 49 | 49 |
| 50 | 50 |
| 51 | 51 |
| 52 | 52 |
| 53 | 53 |
| 54 | 54 |
| 55 | 55 |
| 56 | 56 |
| 57 | 57 |
| 58 | 58 |
| 59 | 59 |
| 60 | 60 |
| 61 | 61 |
| 62 | 62 |
| 63 | 63 |
| 64 | 64 |
| 65 | 65 |
| 66 | 66 |
| 67 | 67 |
| 68 | 68 |
| 69 | 69 |
| 70 | 70 |
| 71 | 71 |
| 72 | 72 |
| 73 | 73 |
| 74 | 74 |
| 75 | 75 |
| 76 | 76 |
| 77 | 77 |
| 78 | 78 |
| 79 | 79 |
| 80 | 80 |
| 81 | 81 |
| 82 | 82 |
| 83 | 83 |
| 84 | 84 |
| 85 | 85 |
| 86 | 86 |
| 87 | 87 |
| 88 | 88 |
| 89 | 89 |
| 90 | 90 |
| 91 | 91 |
| 92 | 92 |
| 93 | 93 |
| 94 | 94 |
| 95 | 95 |
| 96 | 96 |
| 97 | 97 |
| 98 | 98 |
| 99 | 99 |
| 100 | 100 |

Colorcode: Colours represent LEP only, not Topography



ATTACHMENT A



Sydney Local Environmental Plan 2012

Proposed Height of Buildings Map - Sheet HOB_018

| Letter | Maximum Building Height (m) |
|--------|-----------------------------|
| A | 3 |
| Z | 55 |
| E | 6 |
| AA1 | 60 |
| H | 7.5 |
| AA2 | 65 |
| J | 8 |
| AA3 | 70 |
| K | 9 |
| AB1 | 80 |
| L | 11 |
| AB2 | 85 |
| M | 12 |
| AC | 110 |
| N | 15 |
| AD | 130 |
| O | 15 |
| AE | 150 |
| P | 18 |
| AEH | 235 |
| R | 22 |
| S | 24 |
| T1 | 25 |
| T2 | 27 |
| T3 | 28 |
| T4 | 29 |
| U1 | 30 |
| U2 | 33 |
| V | 35 |
| W1 | 40 |
| W2 | 42 |
| X | 45 |
| Y | 50 |

Subject to Change

Cadastral

Cadastrate 17/10/2013 © City of Sydney

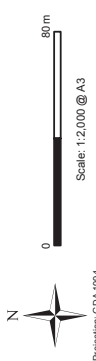
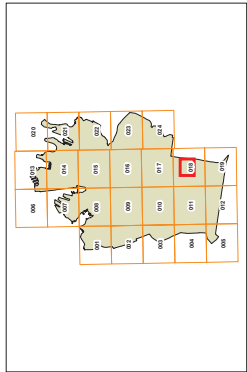

Projection: GDA 1994 Zone 56

Map identifier number: 2202_CDM_HOB_018_005_20131030

Part 5: Community Consultation

The draft Planning Proposal and draft DCP amendments were placed on public exhibition from 25 March to 07 May 2014. Exhibition materials were made available for viewing at the CBD, Redfern, and Green Square Neighbourhood Centres and on the City's website. The City sent letters to landowners within the Epsom Park Precinct and surrounding landowners to notify them of the public exhibition. The exhibition was also advertised in the Southern Courier and Central Courier newspapers.

One public submission was received from Design Collaborative (on behalf of Suttons Motor Group, the landowner for 118-130 Epsom Road and 905 South Dowling Street (now Link Road)). The submission raised concerns about the change to the LEP height map for the north-east corner of the Suttons sites- from 40 metres to 35 metres. A further concern was raised regarding changes to the building layout in the southern portion of the Suttons site.

In response, the change to the height limit for a small portion in the north-east of the site reflects the height in storeys achievable under the current DCP controls (10 storeys). In the southern portion, the amendment reflects that this portion is set aside as a road reservation in the DCP. This is shown clearly on the LEP map. Both of these amendments are corrections to the LEP height of buildings map and do not affect the development potential of the site. The City is not proposing to change the LEP maps as a result of the submission.

Part 6: Project Timeline

The following project timeline will assist with tracking the progress of the Planning Proposal through its various stages of consultation and approval. The City's aim is that this amendment to *Sydney Local Environmental Plan 2012* (Sydney LEP 2012) will be completed by August 2014.

| | Late November 13 | December 13 | January 14 | February 14 | March 14 | April 14 | May 14 | June 14 | July 14 | August 14 | September 14 | October 14 |
|---|------------------|-------------|------------|-------------|----------|----------|--------|---------|---------|-----------|--------------|------------|
| Stage 1: Submit to Department of Planning and Infrastructure | | | | | | | | | | | | |
| Gateway Panel consider planning proposal | | | | | | | | | | | | |
| Stage 2: Receive Gateway Determination | | | | | | | | | | | | |
| Stage 3: Prepare documentation for public exhibition | | | | | | | | | | | | |
| Stage 4: Public exhibition of the planning proposal (assume 28 days) | | | | | | | | | | | | |
| Stage 5: Review submissions received during public exhibition | | | | | | | | | | | | |
| Stage 6: Prepare report to Council and Central Sydney Planning Committee (CSPC) | | | | | | | | | | | | |
| Stage 7: Council and CSPC meetings | | | | | | | | | | | | |
| Stage 8: Forward endorsed planning proposal to Department of Planning and Infrastructure with request that the amendment is made | | | | | | | | | | | | |
| Stage 9: Amendment to <i>Sydney Local Environmental Plan 2012</i> legally drafted and made | | | | | | | | | | | | |

ATTACHMENT A

APPENDIX 1

Green Square Aquatic Centre and Gunyama Park: Site Layout document

City of Sydney
Town Hall House
456 Kent Street
Sydney NSW 2000

Green Square Aquatic Centre and Gunyama Park – Site Layout



Sydney2030/Green/Global/Connected
city of villages



Acknowledgement

This report has been prepared in collaboration with Conybeare Morrison International Pty Ltd and the following units from the City of Sydney:

- City Life Unit
- City Planning Unit
- City Projects and Property Unit
- Green Square Unit
- Urban Renewal Unit

Table of Contents

| | |
|---|-----|
| Acknowledgement | ii |
| Table of Contents | iii |
| Introduction | 1 |
| Overview | 1 |
| Planning Context | 3 |
| Planning Scheme | 3 |
| <i>Local Environmental Plan</i> | 3 |
| <i>Development Control Plan</i> | 3 |
| Site Description | 4 |
| Site Boundaries | 4 |
| Site Development Conditions | 4 |
| Transport and Access | 4 |
| Proposed Development | 5 |
| Development Brief | 5 |
| Key Design Principles | 5 |
| Connectivity | 7 |
| Built Form | 7 |
| <i>Aquatic Centre Reference Images</i> | 8 |
| <i>Gunyama Park Reference Images</i> | 9 |
| Site Master Plan Proposal | 10 |
| Urban Environment | 10 |
| Indicative Site Layout and Built Form | 11 |
| Indicative Built Form – View toward corner of Joynton and Zetland | 12 |
| Indicative Layout of the new Aquatic Centre and Gunyama Park | 13 |
| Solar Access Diagrams | 14 |
| Indicative Built Form of Green Square Town Centre and Surrounds | 15 |
| Staging of Works | 16 |

Introduction

Overview

Green Square is Australia's biggest urban development, set to deliver 20,000 new homes, 40,000 new residents and 22,000 new jobs by 2030. The 14-hectare Green Square Town Centre will be at this heart of the growing community.

The Green Square development offers a once-in-a-lifetime opportunity to create lively new public spaces and state-of-the-art community facilities, and the City of Sydney has set aside more than \$400 million to ensure the new development is a world leader in sustainability and design excellence.

This Master Plan – Site Layout for Green Square Aquatic Centre and Gunyama Park outlines the City's proposal to provide a new recreation centre and park. With quality networks for walking, cycling and public transport and convenient connections to the city centre and the airport, these much-needed facilities will attract both local and regional visitors.

The preliminary development brief that is part of this plan is based on extensive community feedback and allows for a fully-accessible aquatic centre. Recreation facilities include an Olympic-sized swimming pool, a warm water pool, a hydrotherapy pool and gym areas. A transparent building structure will make the most of natural light, while shaded open spaces and a creche and café facilities will make the centre an inviting community hub.

Gunyama Park will include a full-size multipurpose playground and playground.

Both the Green Square Aquatic Centre and Gunyama Park will complement the spectacular Green Square Library that is now in the final stages of design and they will integrate with the recently-announced public art program for Green Square.

The below-ground library design by award-winning architects Stewart Hollenstein with Colin Stewart Architects also provides for a range of community uses. It will include an amphitheatre, a sunken garden, music rooms, a tower for movie projections, and a children's water play area. A giant glass wedge will sit above the library, with a grassed tramway and wide open spaces for festivals. To unify the library, aquatic centre and the public domain, a major new artistic program for Green Square will be led by top public art curator Amanda Sharrad and the City of Sydney Public Art Advisory Panel.

Along with the Green Square Library, the City of Sydney intends the Green Square Aquatic Centre and Gunyama Park to be an oasis for the whole Green Square community – and one of the most exciting new places to be in Sydney.

The Green Square Aquatic Centre and Gunyama Park site adjoins the Green Square Town Centre in a new Epsom Park precinct.



Figure 1: Regional context

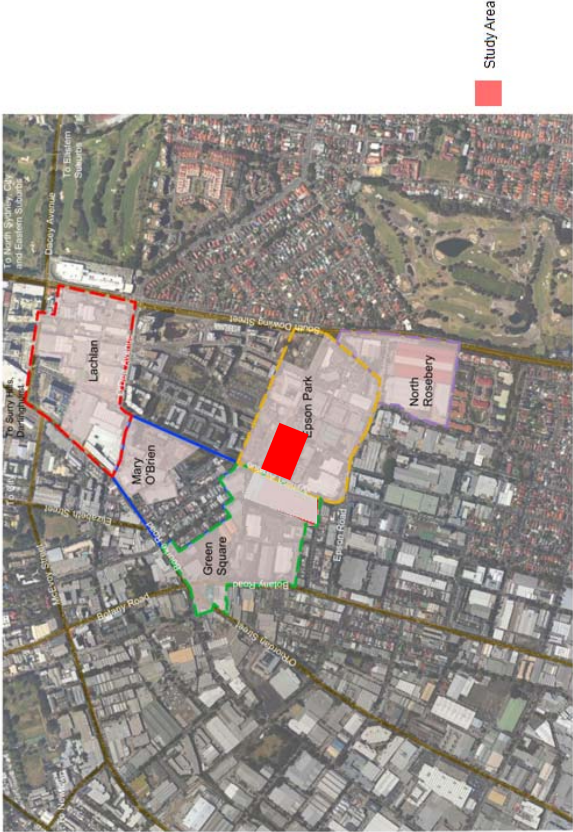

Figure 2: Study area

Preliminary investigation and site schematic works have been done for the site, and this master plan presents the objectives, planning constraints and proposed layout of the new Green Square Aquatic Centre and Gunyama Park site.

The master plan was developed by the City of Sydney with specialist advice provided by Urban Design and Architectural consultancy Conybeare Morrison International Pty Ltd.

Planning Context

The proposed Green Square Aquatic Centre and Gunyama Park is in the new Epsom Park Precinct, east of Green Square Town Centre. Within the next 5-10 years, Epsom Park will undergo significant urban renewal for high density residential uses, including retail and community uses and open space.

The key planning controls and strategic documents that apply to Epsom Park include:

- Sydney Local Environmental Plan 2012 (Sydney LEP 2012)
- Sydney Development Control Plan 2012 (Sydney DCP 2012)
- Contaminated Land Development Control Plan 2004

Planning Scheme

Local Environmental Plan

The Green Square Aquatic Centre site is zoned SP2 Community Facility and B4 Mixed use under Sydney LEP 2012. The City is reviewing the zoning provisions to better achieve Council's vision for the site.

Development Control Plan

The Sydney DCP 2012 falls under the Sydney LEP 2012 and also applies to the proposed Green Square Aquatic Centre.

The Green Square Aquatic Centre is part of the Epsom Park locality as covered in Section 2 of the DCP. The Locality Statement for the Epsom Park area is:

This locality is bound by Kirby Walk to the north, South Dowling Street and Link Road to the east, Epsom Road to the south and Joynton Avenue to the west.

Epsom Park is to be a new neighbourhood with a strong sense of place and public life, where residents enjoy proximity to the City, easy access to the Green Square Town Centre, good transport links, open parklands, and specialty retail activities. It is to have a strong urban character and identity built on the quality of the streets, architecture, good public transport, facilities and services.

Like Victoria Park to the north, it is to provide a fine grain permeable built form that offers a range of dwelling types. The buildings are to be at a human scale, and streets will integrate with those in surrounding neighbourhoods to provide permeability and maximising pedestrian movement.

The heights of buildings are to respond and enhance the character of the streets, helping to reinforce the character of the neighbourhood. A central neighbourhood park of 15,500sqm will provide space for active sports, passive recreation and stormwater detention. It is also located adjacent to the proposed Green Square Health and Recreation Centre, which includes aquatic and medical facilities.

The development of Epsom Park is to embrace sustainability, with an integrated approach to addressing stormwater management and provide equity of access for pedestrians, cyclists and vehicles.

Section 3.1.5 of the DCP contains specific provisions that relate to the design of public open space. Key objectives include:

- (a) *Provide high quality and publicly accessible open space in urban renewal areas.*
- (b) *Ensure the design of open space provides for a variety of both passive and active uses appropriate to the location and can respond to community needs.*
- (c) *Provide corridors of locally indigenous vegetation that link major open spaces and water bodies to enhance environmental quality and optimise opportunities for habitat for native flora and fauna species.*
- (d) *Ensure that open space is strategically located to assist with water sensitive urban design and stormwater management.*

Site Description

Site Boundaries

The proposed site has direct frontage to Joynton Avenue to the west. Once developed, it will be bounded by Zetland Avenue to the north, Peters Drive to the south and Julius Avenue to the east.

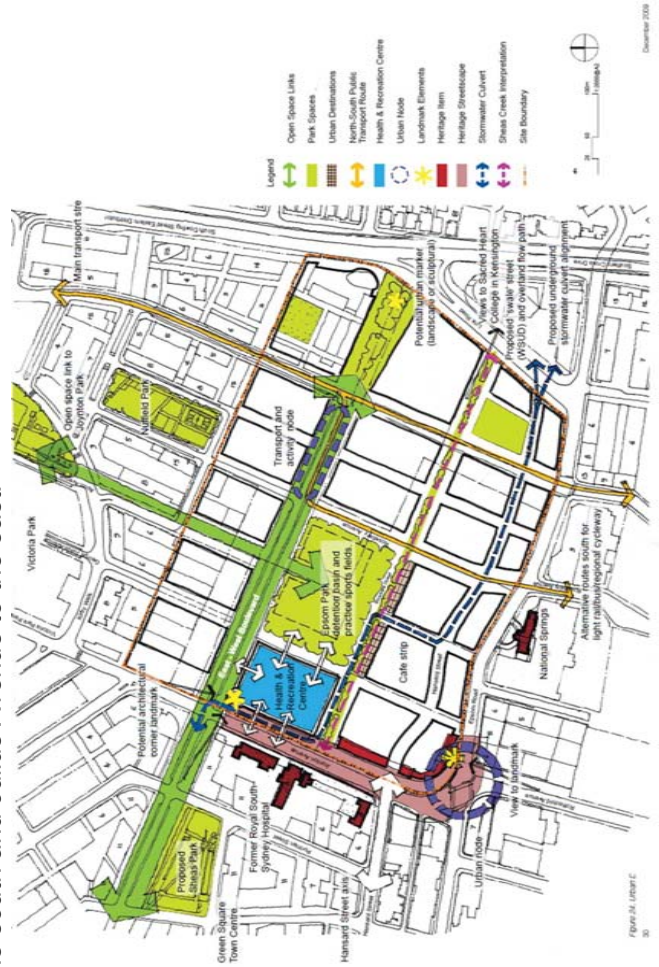

Figure 3: Site boundaries

Site Development Conditions

When developing the site, the following conditions and restrictions apply:

- The final levels for Joynton Avenue;
- The proposed location of the trunk drainage identified by Council and Sydney Water Corporation;
- The relocation of an 840 millimetre diameter water main;
- The restrictions by Roads and Maritime Services for the proposed signalised intersection at Joynton Avenue and Zetland Avenue;
- The proximity of proposed future residential development and the need to maintain residential amenity;

- The aquatic centre and park are accessible with convenient connections from the site to the rest of Sydney including the Green Square Town Centre, the city centre and the airport;
- Public transport and a high-quality, safe network of walking and cycling infrastructure surround the site;
- There are opportunities for seamless connections with neighbouring precincts and between transport modes to encourage non-car based travel; and
- The site is ideally located to attract both local and regional aquatic centre and park visitors.

Transport and Access

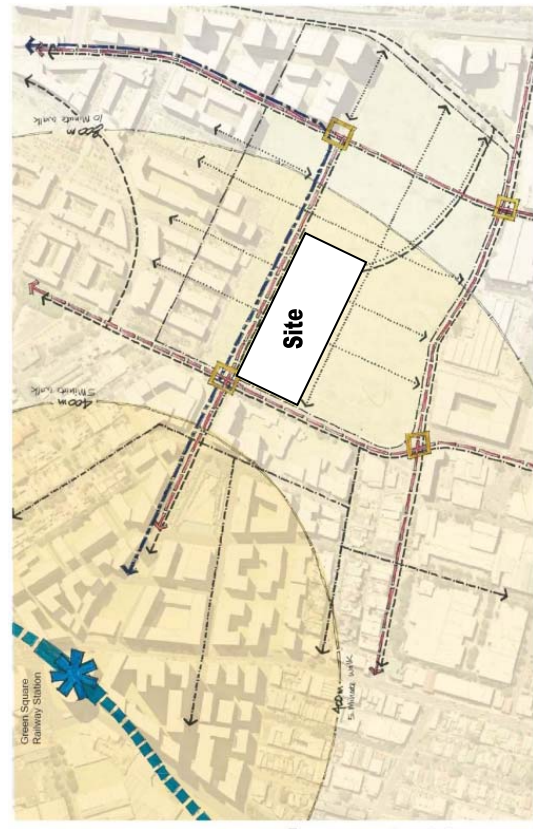

- The need to protect, retain and enhance the grand scale of street trees along Joynton Avenue;
- The redevelopment of the Royal South Sydney Hospital and proposed future community uses;
- The need to integrate street trees along the east-west boulevard with open space to provide a green link to the park and enhance the landscaped character of the neighbourhood; and
- The function of the east-west boulevard to provide ample space for generous footpath areas to accommodate outdoor dining areas, dedicated bicycle paths, future light rail (or interim bus service), local vehicular access and car parking.

Proposed Development

Development Brief

The design development brief is based on feedback and responses received from extensive community consultation.

The development will:

- Create a new aquatic centre and precinct recreation park on the site;
- Provide spaces for indoor and outdoor recreation and leisure;
- Provide and accommodate a range of aquatic and fitness uses, as well as a multipurpose community space;
- Complement the community facilities in Green Square Town Centre, including the new library and Neighbourhood Service Centre, and the community and cultural facilities on the neighbouring South Sydney Hospital site; and
- Accommodate up to 100 underground car spaces.

Aquatic Centre approx. 7,000 m²

- Indoor 51.5m swimming pool
- Spectator seating
- 25m warm water program pool
- Indoor leisure water area
- Hydrotherapy pool
- Rehab gym area
- Gym (weights and cardio)
- Dry program/multipurpose rooms
- Multipurpose recreation space
- Wet/dry amenities and change rooms
- Entry/reception/foyer/retail/admin
- Café and seating
- Creche with outdoor space for centre users
- Underground parking – approx.100 spaces

Gunyama Park approx 16,500 m²

- Full-size synthetic multipurpose playfield
- Playground
- Public amenities
- Outdoor circuit training

Key Design Principles

The following principles (from the City of Sydney’s Aquatic Development Strategy) will be developed further in the design process for the Green Square Aquatic Centre:

- The overall centre should provide significant social opportunities for all sections of the community to experience what is on offer. Users should feel comfortable to use that facility on a social basis as well as an active recreation basis;
- The facility will have a clear and articulated entry point. The entry should not rely upon signage, but should clearly identify itself from both a marketing and image perspective;
- The relationship of ‘front door’ of the facility to the car parking areas is of prime importance for the safety of users during out-of-hours use;
- The building should provide equity of access for all groups with the provision of disability access to all areas, not just specific facilities designed for such use. Disability discrimination should be eliminated completely;
- Ideally, the orientation of the building should be on an east-west axis to maximise exposure to the sun’s tracking through the sky;
- Principle outdoor areas ideally would be oriented to the north with access from the indoor and outdoor aquatic facilities;
- Large facilities such as the dry recreation facilities should be located to ensure no overshadowing of important outdoor spaces or entrance areas takes place;
- Access for delivery vehicles to plant rooms and first aid area should be clear and logical and away from public access;
- The building should be planned in a clear and logical progression to ensure that expansion of all principal area is possible over the life of the facility;
- The building architecturally should be as transparent as possible, both to ensure a cross selling of the activities within the centre so the public are aware of what is on offer, but also to allow natural light to enter the facility;

ATTACHMENT A

- Toilet change areas should provide both wet and dry access and be fully accessible for all users. Unisex family facilities should also be provided which again are fully accessible. Dry change rooms should be adjacent to dry program areas such as the gym and program rooms;
- Creche facilities would be accessed from the main foyer, adjacent to café areas;
- Outdoor play spaces associated with the crèche should be in sunny areas but away from principle circulation paths;
- The aquatic areas would open out from the foyer areas with direct access to change facilities. Large glass door would lead to the outdoor areas. The pools should be laid out in a clear and logical manner to ensure minimisation of life guards and to ensure the pool hall is zoned for all key user groups. Large concourse areas should be provided to leisure water areas to allow casual seating in groups, especially adjacent to the café facilities. Concourse areas to the more formal pools should also allow for temporary tiered seating if required for competition use;
- The entry to any facility should be open and inviting, providing ease of access for all users. Foyer areas should allow orientation and assembly of groups prior to the arrival at reception points;
- Reception points should allow separation of users if required, especially if carnivals are to be held in the facility. The design of specific reception areas should provide a welcoming and friendly control over all users of the facility. A face-on reception desk should be reviewed and integrated with the specific management style adopted within the centre;
- The internal circulation spaces should be economical and should not rely on a series of internal corridors. They should be configured to create opportunities for social interaction either before or after use;
- Central café facilities should encourage users to 'stay on' within the facility. The café, if possible, should be accessible both from within the facility but also outside the facility (without going through reception) to allow all sections of the community to use the café.
- The café should be able to work as a destination in its own right and be linked with walking and/or cycle tracks. This is especially important for users within a total recreation precinct;
- Toilet areas should open from principle circulation areas to provide safety for all users;
- Operation costs should be fully examined and understood through the design process. Reference should be made to the management groups to fully explore cost reduction policies and staffing levels;
- Expansion over the life of the facility should be examined to provide clear logical expansion of all areas. Expansion should be based upon the principles of a customer-interest lifecycle;
- The construction techniques and material usage must reflect the severe atmosphere inherent in these facilities and should acknowledge the structural lifecycle of construction and maintenance costs.
- An environmental matrix will be prepared to explore all areas of environmental design possibilities. These possibilities will be measured and examined to fully understand capital and operational cost implications. Only then can true decisions be made in line with Council Environmental Policies;
- Mechanical services should be designed on an understanding of the internal environments they are controlling and make allowance for ecologically sustainable opportunities, such as being shut down during ideal external ambient conditions; and
- Lighting should be zoned to allow efficient running of the facility. Daylighting should be maximised without glare across water. Light types should be selected for the environment they will operate in but should also provide a clear 'colour balance' for user comfort. They should not be located over pool areas.

Connectivity

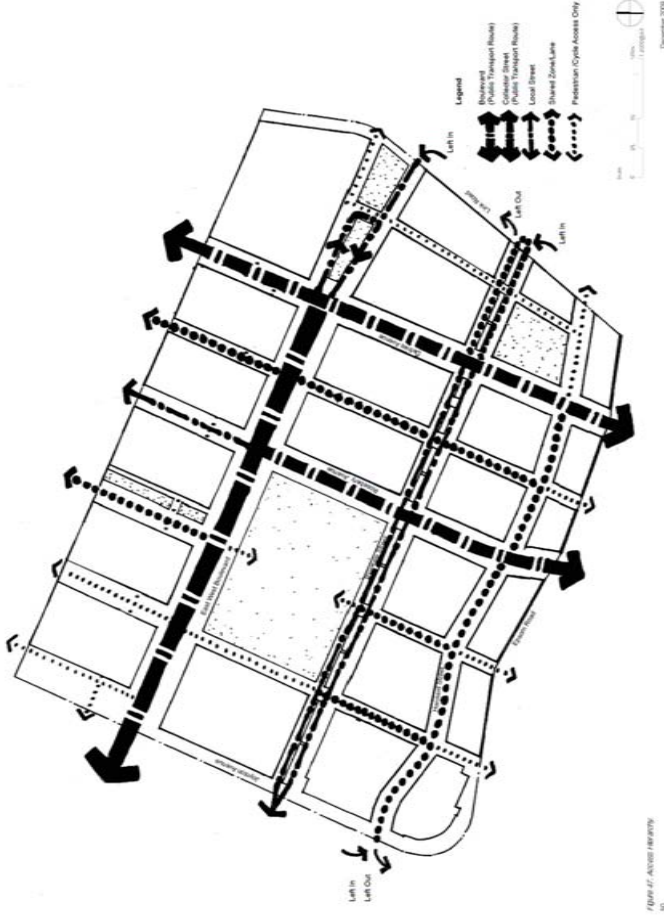

- The public space / public domain area shall be designed to give identity and connection by creating:
 - A through connection between Peters Drive and Zetland Avenue;
 - A continuous landscape frontage to Joynton Avenue that maintains and continue its established streetscape character;
 - A visual connection from the community buildings on the South Sydney Hospital Site across Joynton Avenue through to the proposed Gunyama Park by having part of the aquatic centre as transparent as possible; and
 - A new recreation precinct park surrounded by new roads and new buildings defined by new attractive tree lined streets and apartment buildings with green courts and defining local parks.

Built Form



- The built form shall consist of a new aquatic centre proposed to be one or two storeys and possibly a small kiosk servicing the park. The height of the facility is proposed to be between 15 and 22 metres to allow for a spacious internal amenity;
- No high-rise residential towers are proposed for the site.
- The aquatic centre will overlook the park and have a variety of indoor/outdoor spaces for aquatic and leisure use. The built form will be determined once a design concept has been agreed. The image above is indicative only and not representative of the design of the new facility; and
- The built form will provide an active interface at the site boundaries and reinforces the street alignments.

Aquatic Centre Reference Images

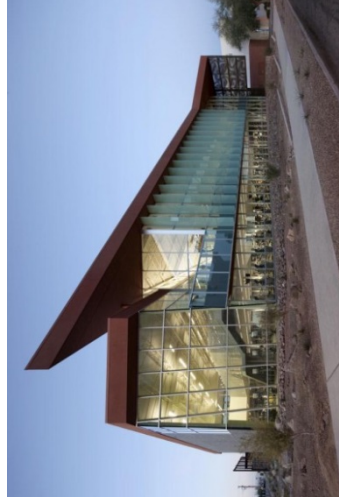
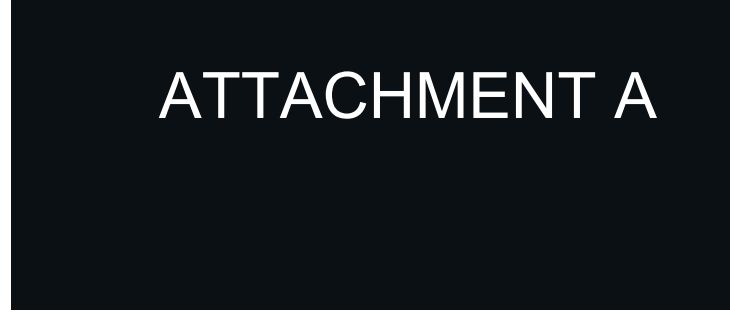
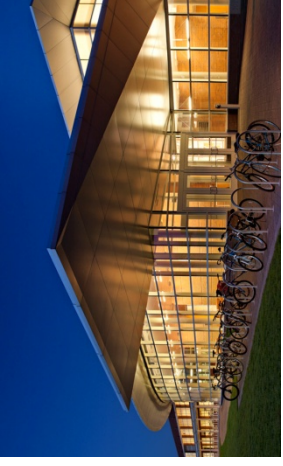

Gunyama Park Reference Images

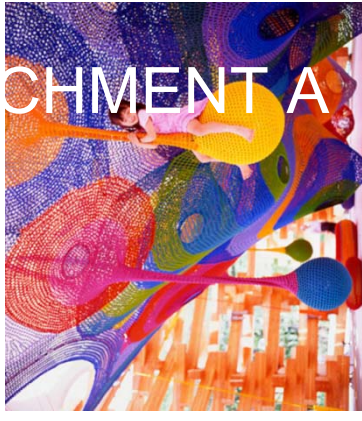

Site Master Plan Proposal

Urban Environment



Figure 4: Proposed urban environment



Figure 5: Conceptual illustration of proposed community facilities through the Green Square Town Centre to Epsom Park

Indicative Site Layout and Built Form



Figure 6: Proposed site layout of the aquatic centre and Gunyama Park site looking west

Indicative Built Form – View toward corner of Joynton and Zetland

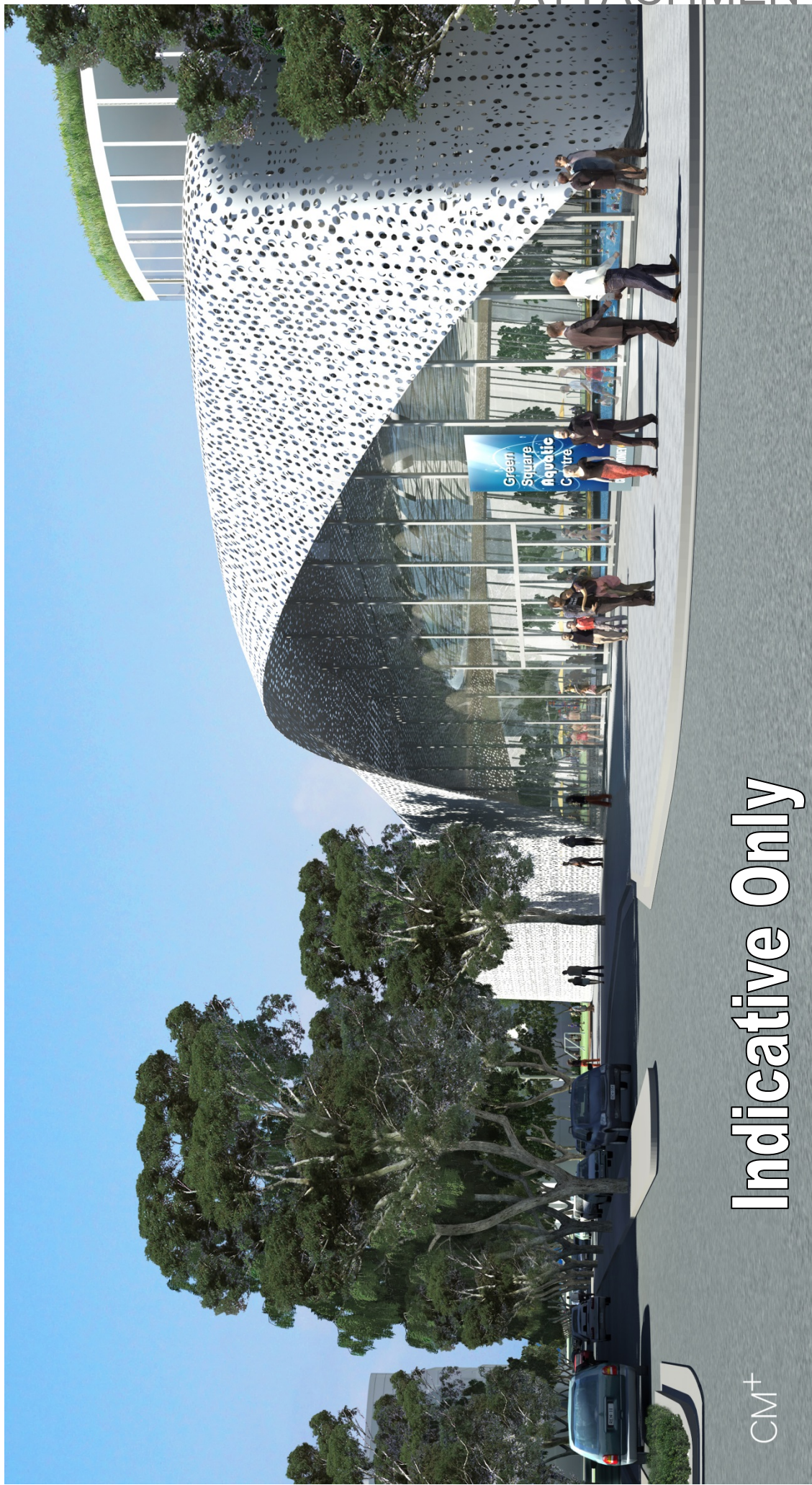

Figure 7: Indicative Built Form of the Proposed Aquatic Centre

Indicative Layout of the new Aquatic Centre and Gunyama Park

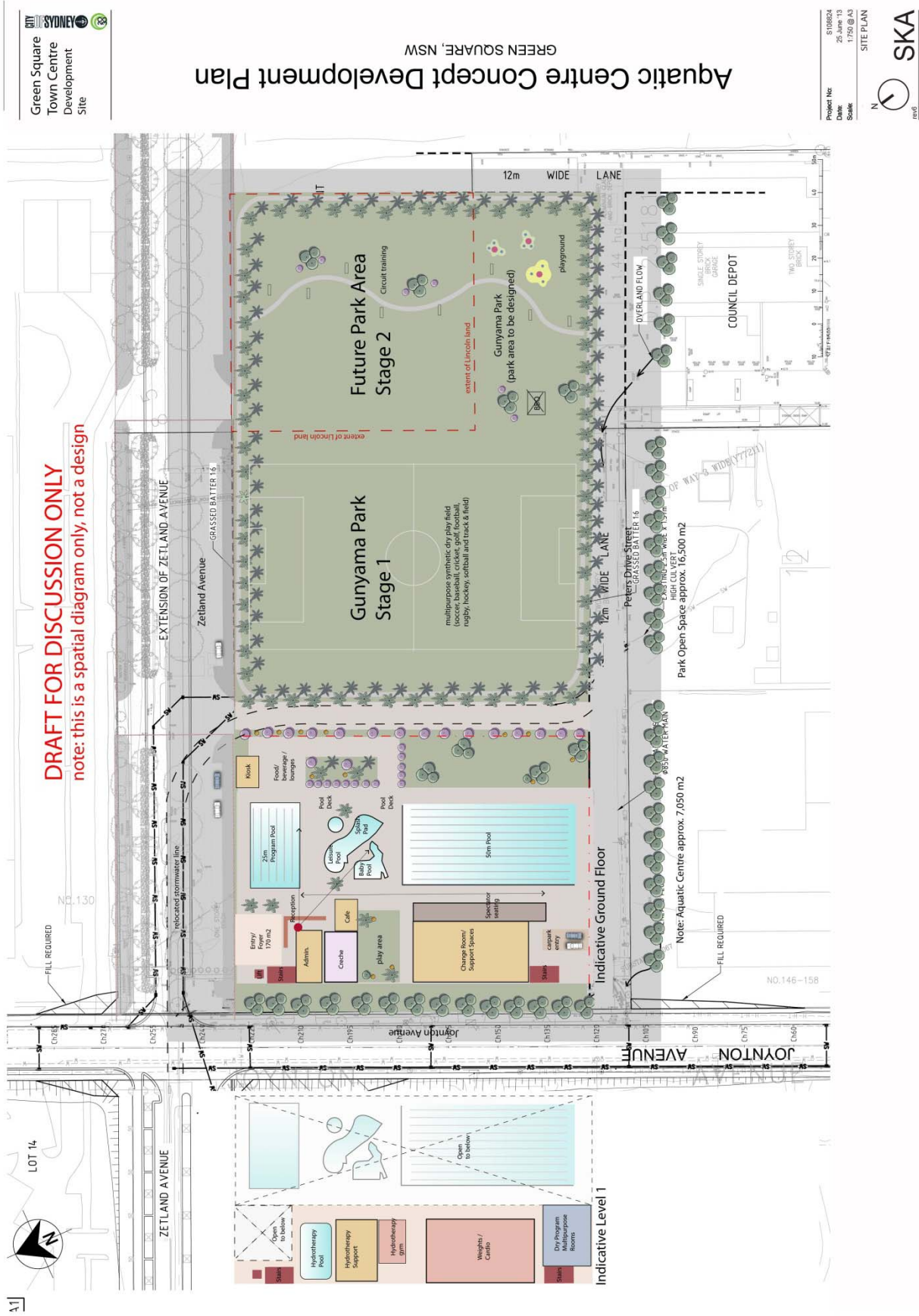
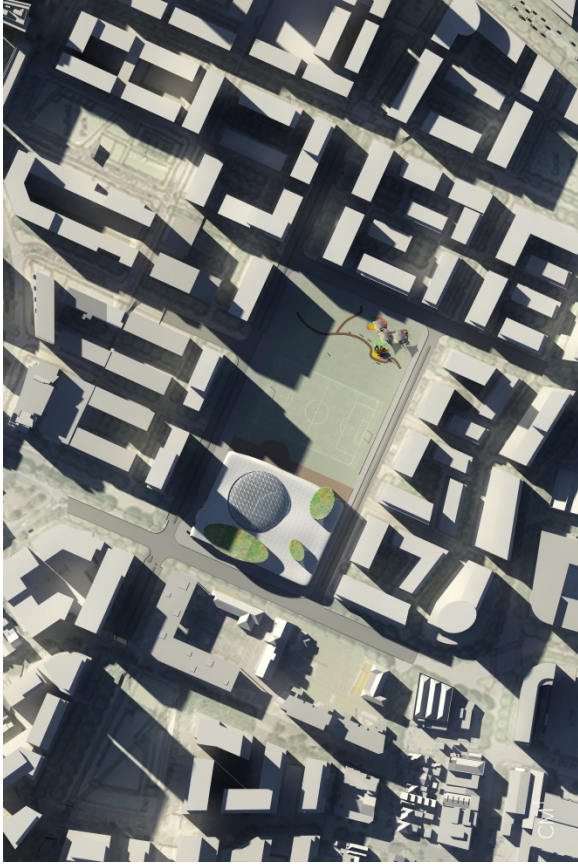
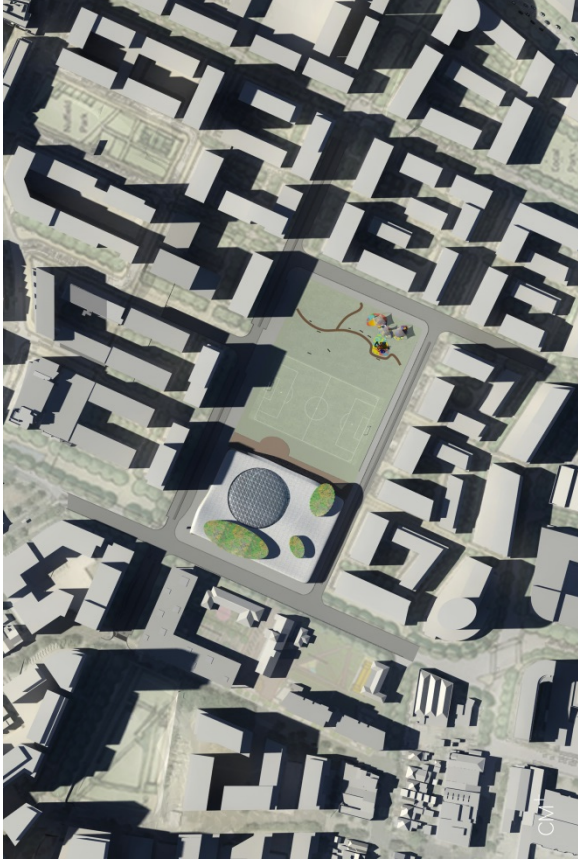

Figure 8: Indicative Layout of the Proposed Aquatic Centre and Gunyama Park

Solar Access Diagrams



9 am June 21



12 pm 21 June



3 pm 21 June

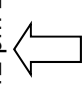

NORTH

The solar access diagrams show the worst case scenario in winter and demonstrate minimal overshadowing of the park and aquatic centre.

Indicative Built Form of Green Square Town Centre and Surrounds

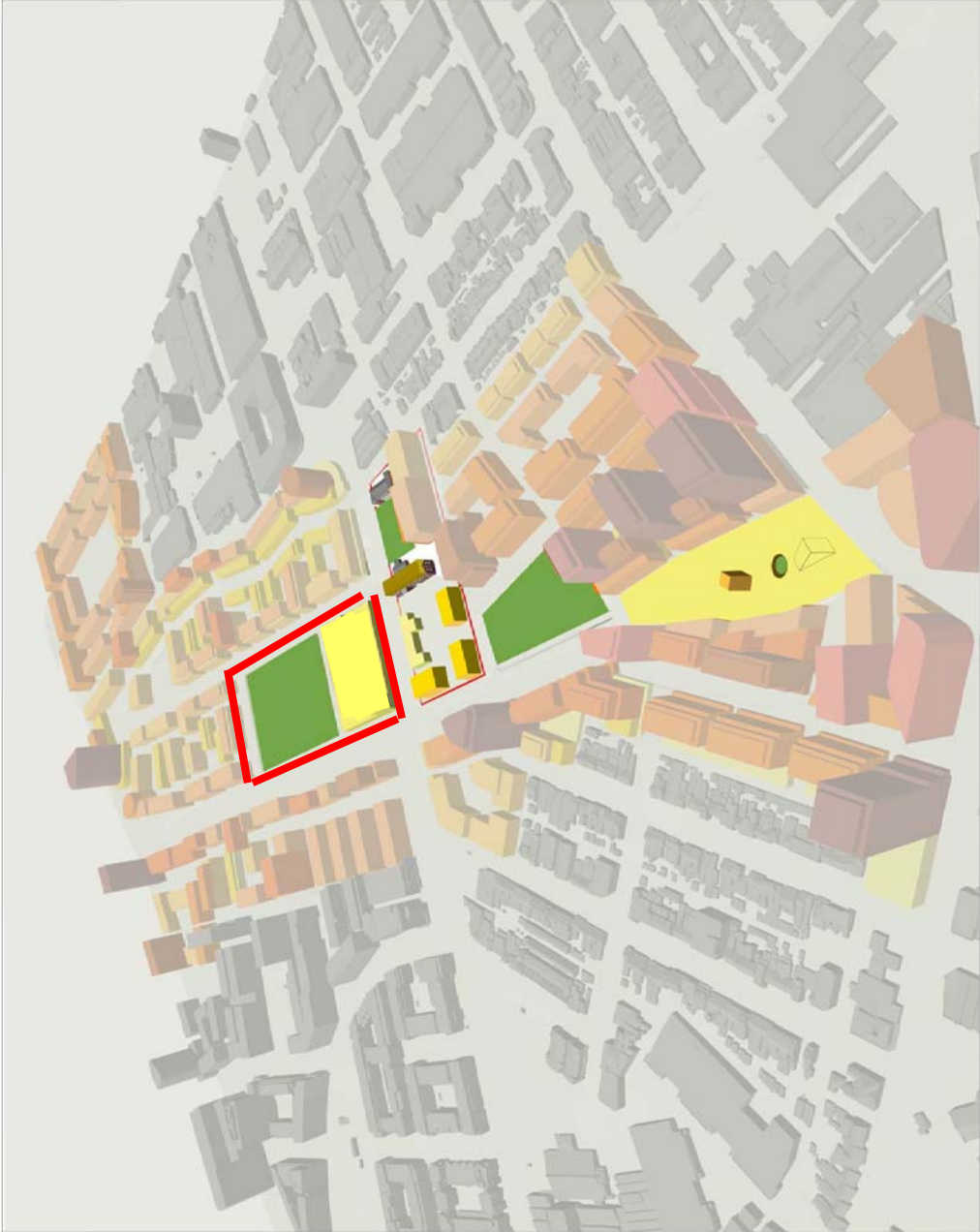

Figure 9: Proposed built form of the site in context of the future Green Square Town Centre and surround

Staging of Works

The works on the aquatic centre and Gunyama Park site are proposed to be done in stages. These are subject to flood mitigation trunk drainage works being undertaken with Sydney Water.

| Staging | Proposed Works | Indicative Construction Timing |
|---------|---|--|
| Stage 1 | Provision of: <ul style="list-style-type: none"> ▪ Aquatic and fitness centre ▪ Hydrotherapy facilities ▪ Café/kiosk ▪ Outdoor synthetic playfield ▪ Outdoor circuit training ▪ Playground ▪ Public amenities ▪ Car parking | 2016/17 – 2018/19 Subject to flood mitigation trunk drainage works by Sydney Water in 2015/16 |
| Stage 2 | Provision of: <ul style="list-style-type: none"> ▪ Additional passive park area ▪ Completion of the park perimeter walking trail | Subject to land dedication with adjacent mixed-use redevelopment |